

Chudleigh Way

Ruislip • Middlesex • HA4 8TP

PCM: £1,900 PCM



coopers
est 1986

This superb two double bedroom property has been extended and is in excellent condition throughout. Ideally situated on one of Ruislip Manor's most sought after roads and providing easy access to Ruislip Manor's shopping and transport facilities. This two Bedroom terraced home consists of a large lounge, modern kitchen and dining area, two double bedrooms, modern fitted bathroom and rear garden. Benefits include gas central heating with modern boiler, double glazing and off street parking.

Fantastic location

Moments walk from Ruislip Manor Station

Parking

Modern bathroom

Excellent condition

Modern kitchen

Two good sized bedrooms

Unfurnished

Local shops, bars & restaurants

Available Date

28th February 2026

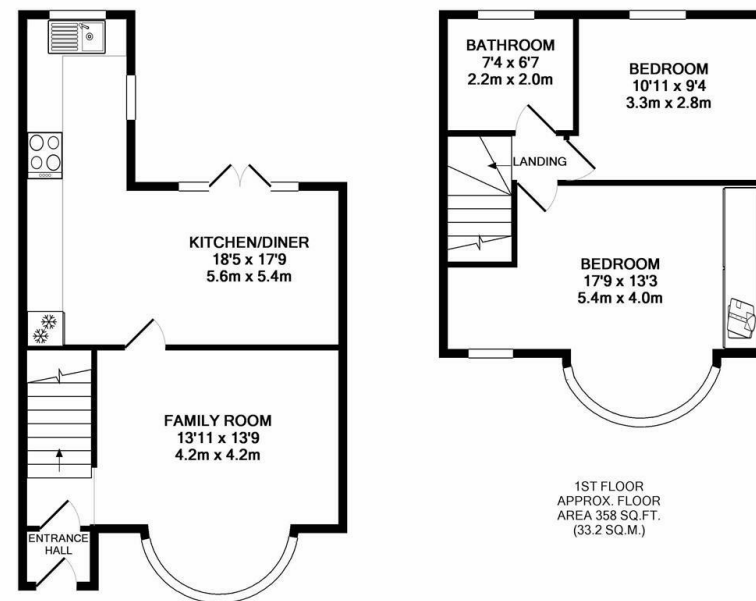

GROUND FLOOR
APPROX. FLOOR AREA 431 SQ.FT. (40.1 SQ.M.)

TOTAL APPROX. FLOOR AREA 789 SQ.FT. (73.3 SQ.M.)

Whilst every attempt has been made to ensure the accuracy of the floor plan contained here, measurements of doors, windows, rooms and any other items are approximate and no responsibility is taken for any error, omission, or mis-statement. This plan is for illustrative purposes only and should be used as such by any prospective purchaser. The services, systems and appliances shown have not been tested and no guarantee as to their operability or efficiency can be given
Made with Metropix ©2019

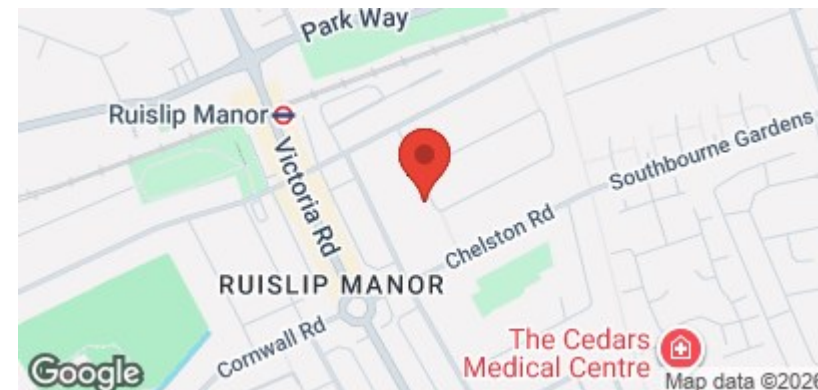

coopers
est 1986

01895 625 625

**126-128 High Street, Ruislip,
Middlesex, HA4 8LL**
rl@coopersresidential.co.uk

CoopersResidential.co.uk

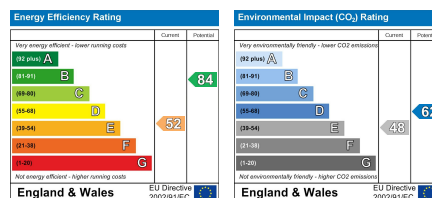

Important Notice: These particulars, whilst believed to be accurate are set out as a general outline only for guidance and do not constitute any part of an offer or contract. Intending purchasers should not rely on them as statements or representation of fact, but must satisfy themselves by inspection or otherwise has the authority to make or give any representation or warranty in respect of the property.