



Guide Price

£425,000

Freehold

3x  1x  2x 

**Westbourne Gardens,
Billericay, Essex, CM12**

OVER 60?

Secure this property
for up to **59% less!**

 **DOUGLAS
ALLEN**
Helping you move forwards



Main features

- Well looked after and modern throughout
- Rear garden with patio area and side access
- Three good size bedrooms with bedroom one having built in storage
- Garage and parking
- Well located for local schools as well as local amenities

Accommodation

GROUND FLOOR

Entrance Hallway
 Lounge : 15'5 x 12'3 (4.70m x 3.74m)
 Kitchen/Dining Room: 15'8 x 9'0 (4.78m x 2.75m)

FIRST FLOOR

Landing
 Bedroom 1: 13'1 x 9'1 (3.99m x 2.77m)
 Bedroom 2: 9'7 x 8'9 (2.92m x 2.67m)
 Bedroom 3: 9'7 x 6'5 (2.92m x 1.96m)
 Bathroom

OUTSIDE

Rear Garden
 Garage
 Parking

Ground Floor
 Approx. 36.5 sq. metres (393.0 sq. feet)

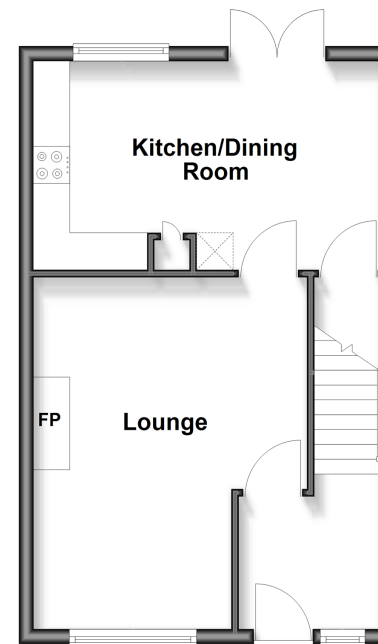

First Floor
 Approx. 36.5 sq. metres (393.0 sq. feet)

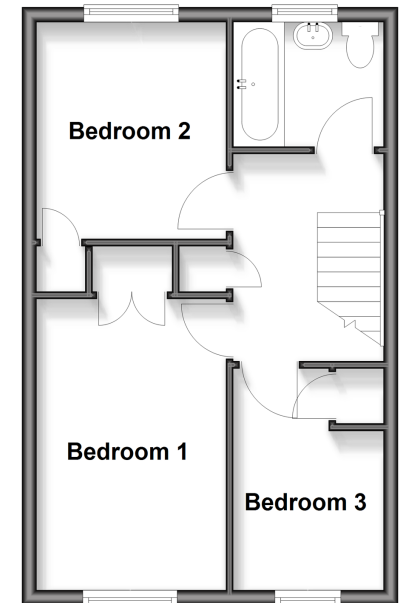

Unable to display material information. Please check with the branch for material information details for this property



50313346/20260418/KM/GJ