

# DAWSONS

Property Professionals since 1925

18/20 STAMFORD STREET STALYBRIDGE CHESHIRE TEL: 0161 338 2292

Website: [www.wcdawson.com](http://www.wcdawson.com) Email: [reception@wcdawson.com](mailto:reception@wcdawson.com)



## Marshall Court, Ashton-Under-Lyne, , OL6 6YA

Situated in the ever popular Cockbrook area, this Roland Bardsley three-bedroomed mid-town house comes onto the market in excellent decorative order and is ideally situated for all local amenities. Offered for sale with No Forward Vendor Chain we would recommend interested parties view the property at their earliest convenience.

**Offers Over £230,000**



**CHARTERED SURVEYORS, ESTATE AGENTS  
& PROPERTY MANAGEMENT SPECIALISTS**



# Marshall Court, Ashton-under-Lyne, , OL6 6YA

- Three-Bedroom Mid Town House
- Well Presented Accommodation
- Off-Road Vehicular Parking
- Cul-de-sac Location
- Excellent Commuter Links
- Good Access To All Local Amenities
- uPVC Double-Glazing
- Gas-Fired Central Heating
- No Forward Vendor Chain

## The Accommodation briefly comprises:

Entrance hallway, lounge with feature fireplace open to the dining area, kitchen with integrated appliances.

To the first floor there are three well-proportioned bedrooms, bathroom/WC.

Externally there is a driveway providing off-road parking and a further forecourt garden. There is an enclosed rear garden.

The property is well placed for all the amenities available in Cockbrook whilst both Ashton-under-Lyne and Stalybridge town centres are within easy reach. There are excellent commuter links and also within easy travelling distance are Stamford Park and Tameside General Hospital.

## The Accommodation in detail comprises:

### GROUND FLOOR

#### Entrance Hallway

Laminate flooring, central heating radiator.

#### Lounge

13'9 reducing to 8'0 x 11'8 reducing to 10'8 (4.19m reducing to 2.44m x 3.56m reducing to 3.25m)

Laminate flooring, feature fireplace, understairs storage cupboard, uPVC double-glazed window, central heating radiator, open to dining area.

8'11 x 7'3 (2.72m x 2.21m)  
Laminate floor, uPVC double-glazed French doors onto the rear garden, central heating radiator.

#### Kitchen

9'3 x 7'4 (2.82m x 2.24m)  
Single drainer stainless steel sink unit, a range of wall and floor mounted units, plumbing for automatic washing machine, built-in stainless steel oven, four-ring ceramic hob with extractor unit over, part tiled, uPVC double-glazed window.

### FIRST FLOOR

#### Landing

With loft access.

#### Bedroom 1

12'11 x 8'3 (3.94m x 2.51m)  
Laminate floor, uPVC double-glazed window, central heating radiator.

#### Bedroom 2

10'4 x 8'4 (3.15m x 2.54m)  
Laminate floor, uPVC double-glazed window, central hearing radiator.

#### Bedroom 3

9'8 x 6'2 including bulkhead storage cupboard (2.95m x 1.88m including bulkhead storage cupboard)  
Laminate floor, uPVC double-glazed window, central heating radiator.

## Bathroom/WC

Panel bath with shower over, pedestal wash hand basin, low-level WC, uPVC double-glazed window, central heating radiator.

## EXTERNALLY

There is a driveway providing off-road parking, forecourt garden.

To the rear there is a flagged an lawn garden section.

## TENURE

Tenure of the property is to be confirmed.

## COUNCIL TAX

Council Tax Band "B".

## VIEWINGS

Strictly by appointment with the Agents.

## AML Checks

We are required by law to conduct Anti Money Laundering (AML) checks for all vendors and purchasers. A non refundable fee of £15 per check will be payable to cover this digital process. These checks are carried out by Thirdfort.

This is a legal requirement to meet HMRC and UK law guidelines .

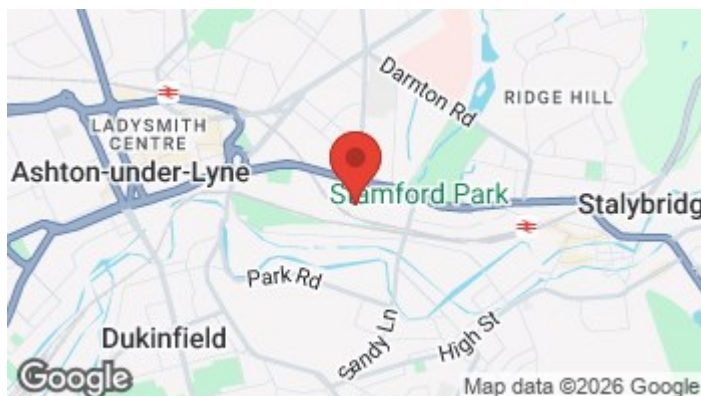

## Directions



# Floor Plan

GROUND FLOOR

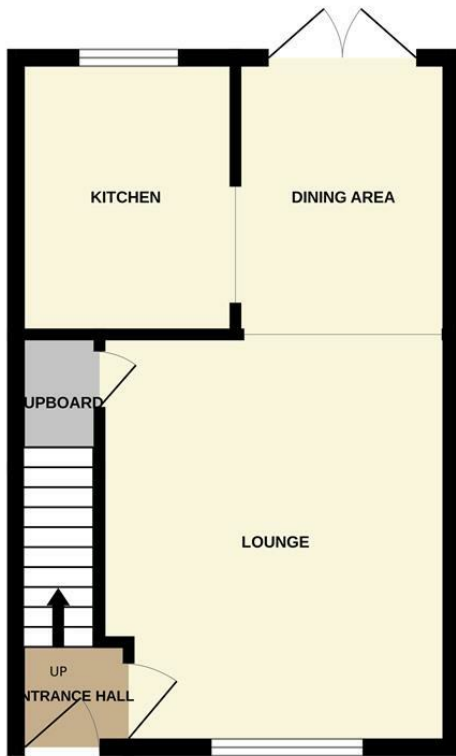

1ST FLOOR

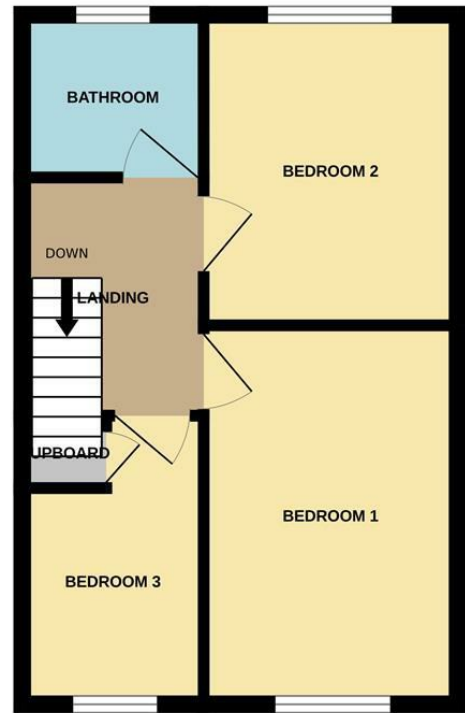

Whilst every attempt has been made to ensure the accuracy of the floorplan contained here, measurements of doors, windows, rooms and any other items are approximate and no responsibility is taken for any error, omission or mis-statement. This plan is for illustrative purposes only and should be used as such by any prospective purchaser. The services, systems and appliances shown have not been tested and no guarantee as to their operability or efficiency can be given.  
Made with Metropix ©2023

These particulars, whilst believed to be accurate are set out as a general outline only for guidance and do not constitute any part of an offer or contract. Intending purchasers should not rely on them as statements of representation of fact, but must satisfy themselves by inspection or otherwise as to their accuracy. No person in this firm's employment has the authority to make or give any representation or warranty in respect of the property.

