



9 Elderwood Gardens

, Middlesbrough, TS6 0GF

Asking price £150,000

A WELL PRICED THREE BEDROOM HOME!

This well looked after three-bedroom semi-detached home is offered in a handy location. The property comes with modern fittings and has off-road parking for two cars. Presented to a high standard with modern interiors. The property benefits from an enclosed rear garden which is accessed from the kitchen diner

This home is well located for local schools, shops and commuting routes throughout Teesside and beyond.

Accommodation is over two floors and briefly comprises; entrance hall, lounge, kitchen, ground floor WC. To the first floor you will find a landing, three bedrooms, one with en-suite and a family bathroom. Externally the property has off street parking for two vehicles and an enclosed rear garden with artificial turf, decking and a summerhouse.

- WELL PRICED FAMILY HOME
- PRIVATE REAR GARDEN
- PARKING FOR TWO CARS
- MAIN BEDROOM WITH EN-SUITE
- EPC RATING B
- EARLY VIEWING IS RECCOMENDED
- GARDEN WITH SUMMERHOUSE

Viewing

Please contact our Progression Property Office on 01642 063352 if you wish to arrange a viewing appointment for this property or require further information.



3



3



1



B

Floor Plan

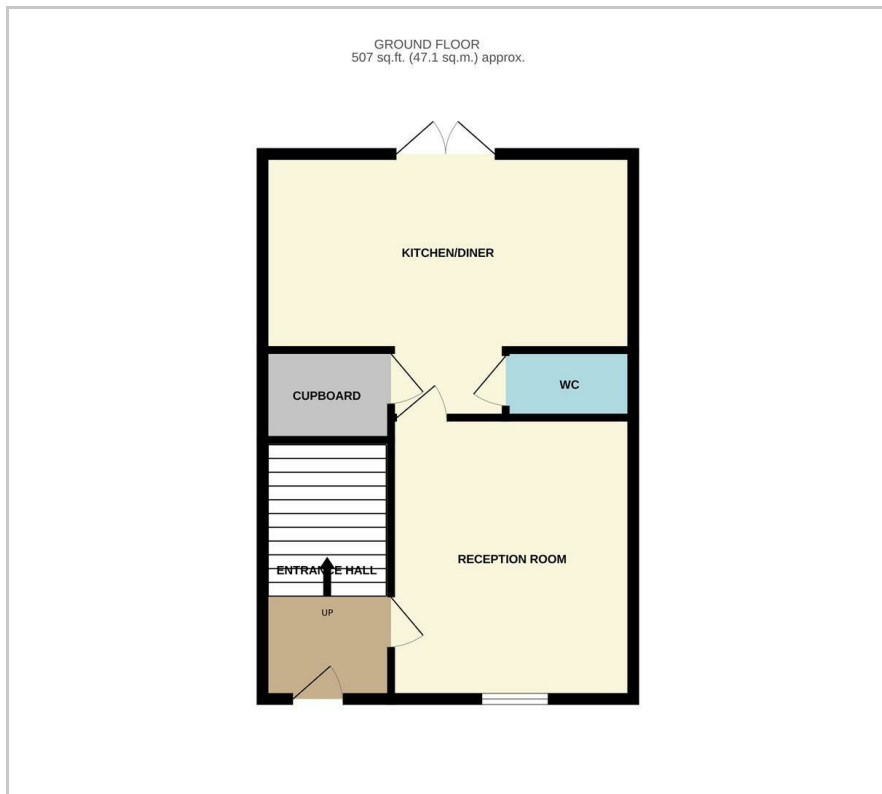

Area Map



Energy Efficiency Graph

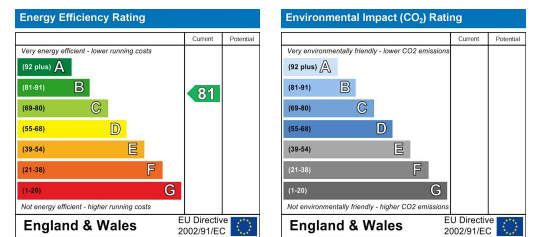

These particulars, whilst believed to be accurate are set out as a general outline only for guidance and do not constitute any part of an offer or contract. Intending purchasers should not rely on them as statements of representation of fact, but must satisfy themselves by inspection or otherwise as to their accuracy. No person in this firm's employment has the authority to make or give any representation or warranty in respect of the property.

329 Linthorpe Road, Middlesbrough, TS5 6AA

Tel: 01642 063352 Email: info@progression-lettings.co.uk <https://www.progression-property.co.uk>