

# Birchwood Road

## BRISLINGTON

APPROXIMATE FLOOR AREA  
73 SQM / 785 SQFT

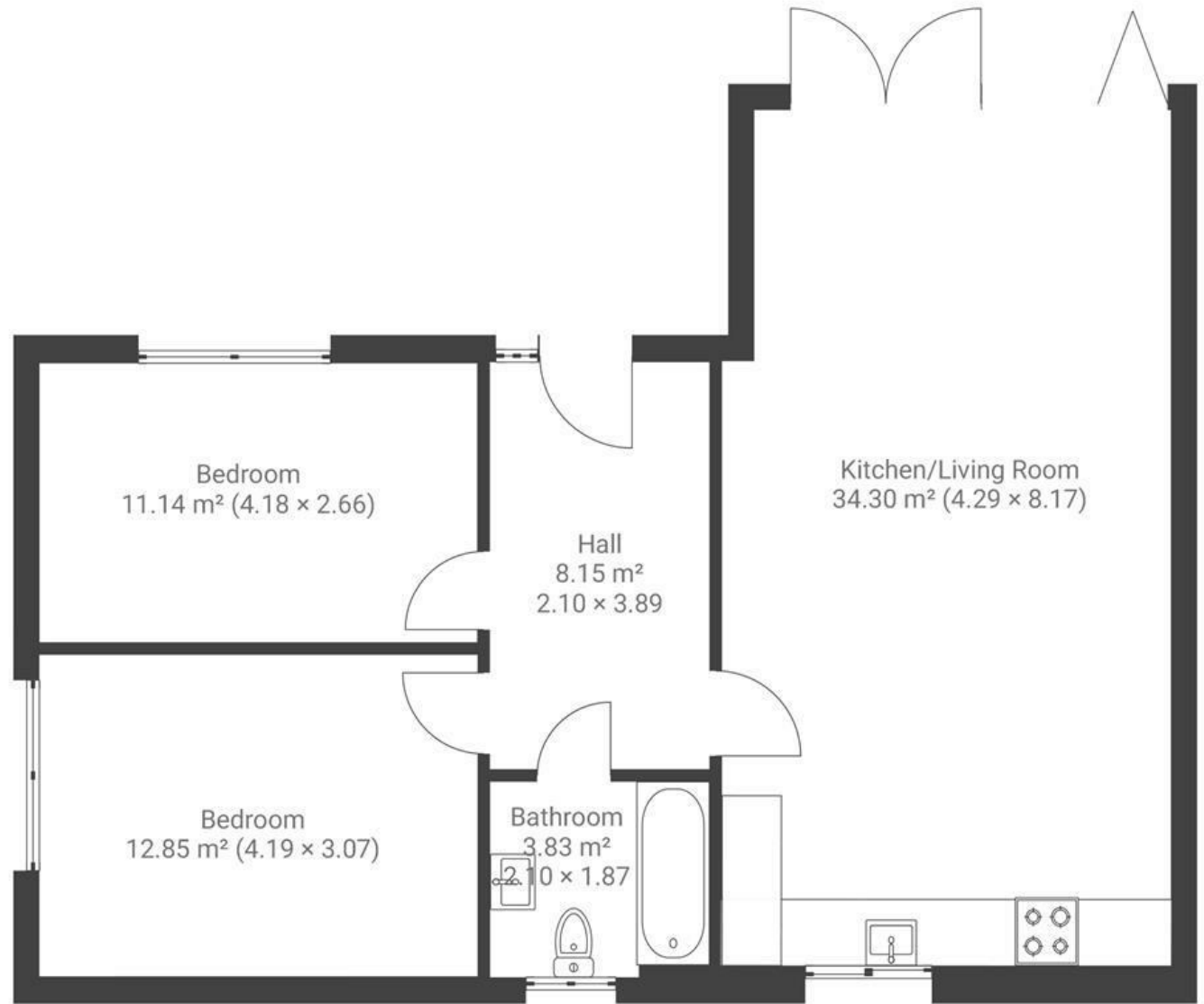

**Boardwalk**

# Birchwood Road

, BRISTOL



£350,000



2 Bedrooms



BS4 4QH



1 Bathrooms

*"Living here has been a genuinely calming and enjoyable experience, with wonderful privacy and an open plan layout that makes everyday life feel relaxed and comfortable. The garden is a real sun trap, staying warm late into summer evenings and making it the perfect peaceful retreat."*

