



Brondesbury Park, NW6

Share of Freehold - £400,000

For sale, a stunning ground-floor apartment in Brondesbury Park. Situated in a well-maintained brick development, this residence offers bright living space throughout.

The property features an expansive reception room with a large bay window that fills the space with natural light and wood flooring. The layout includes a separate kitchen equipped with white cabinetry, slate-grey worktops, and appliances.

The spacious bedroom features wood flooring and a large window. A three-piece bathroom with a full-sized tub completes the accommodation. Residents enjoy access to a large communal garden. The property also benefits from a garage.

Ideally located moments from Willesden Green cafés, it offers superb transport links via Kilburn (Jubilee Line, Zone 2) and Brondesbury Park (Overground, Zone 2).



020 7328 2828

enquiries@cameronsstiff.co.uk

cameronsstiff.co.uk



Brondesbury Park, London, NW6 7BP

Approximate Area = 650 sq ft / 60.4 sq m

For identification only - Not to scale

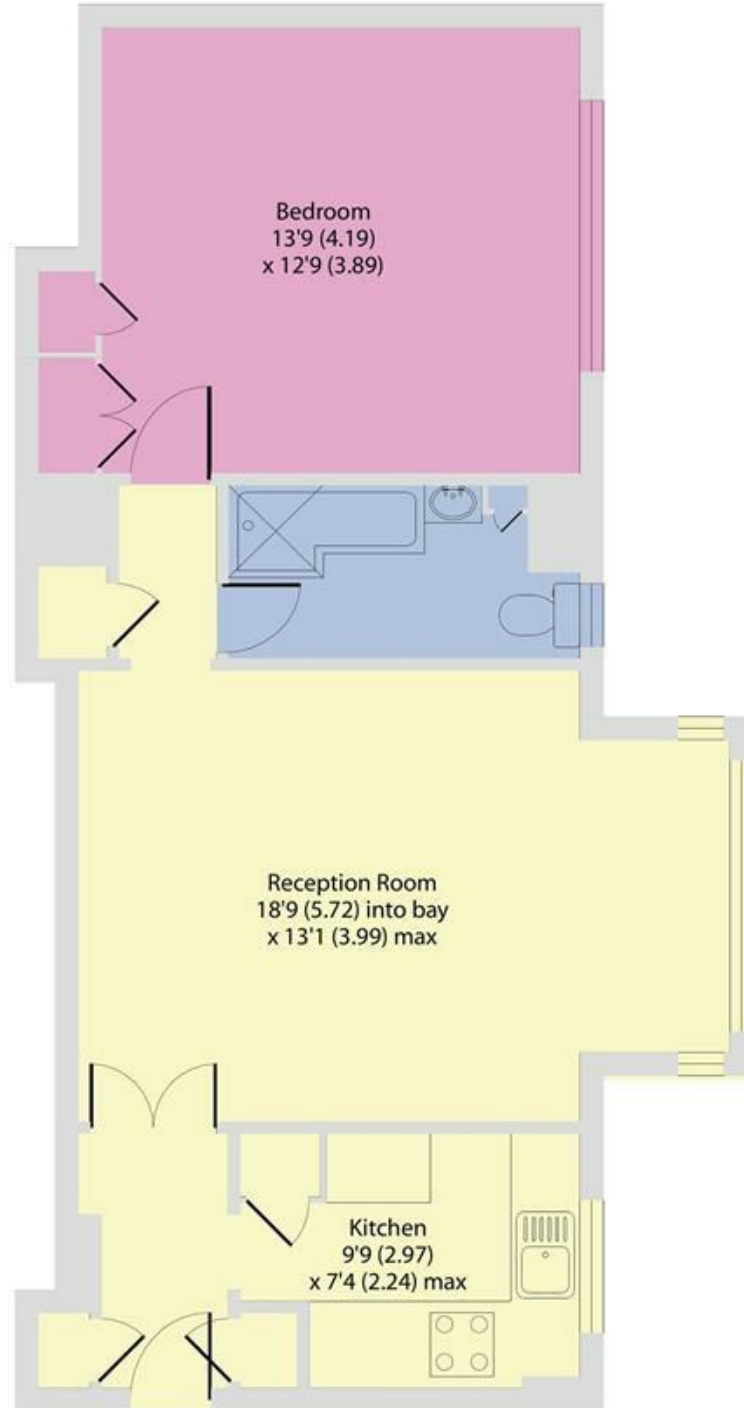

GROUND FLOOR

EPC: C

Ref: 19720708



Floor plan produced in accordance with RICS Property Measurement Standards incorporating International Property Measurement Standards (IPMS2 Residential). © nichecom 2024. Produced for Camerons Stiff & Co. REF: 277326

