

Gatesby Court, Hatcham Street, SE26

1 1 1



Stylish fifth-floor one bedroom apartment in Gatesby Court, offering 592 sq ft of bright, modern living with a private balcony and open views. Features include a spacious open-plan kitchen/reception room, double bedroom with walk-in wardrobe, contemporary bathroom and allocated gated parking. Residents enjoy a gym, concierge and communal gardens, just two minutes from Lower Sydenham station and close to Beckenham Place Park.

Key Features

- Please Quote RF0924 for all enquiries
- One bedroom fifth floor apartment
- Private balcony with views over Crystal Palace training grounds
- Contemporary bathroom
- 24-hour gym and concierge service
- A Property That Must Be Seen to Be Fully Appreciated
- Approx. 592 sq ft of accommodation
- Double bedroom with walk-in wardrobe
- Allocated gated parking space
- Two minutes from Lower Sydenham station

Gatesby Court, Hatcham Street, SE26

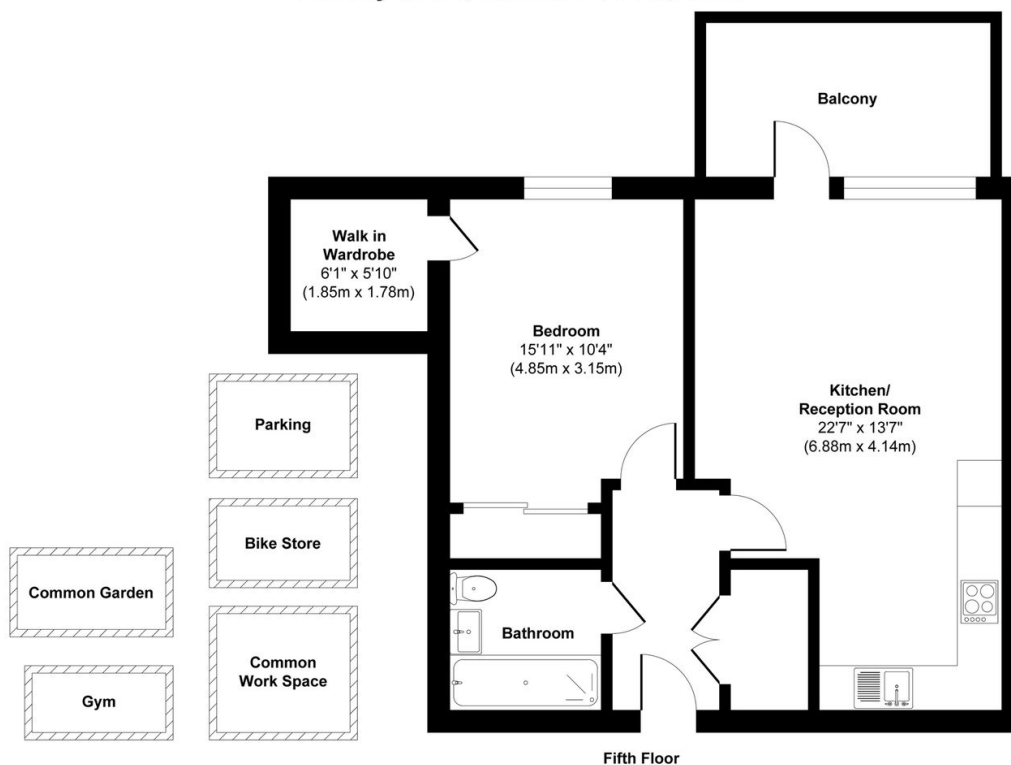

Approx. Gross Internal Floor Area 592 sq. ft / 55.00 sq. m

Illustration for identification purposes only, measurements are approximate, not to scale.

Produced by Elements Property