



Coverdale Road, NW2 Share of Freehold - £625,000

Available for Sale is this stylish two-bedroom Top-Floor flat, set within a well-maintained low-rise development in the heart of Brondesbury Park.

Offering approximately 831 sq ft of well-proportioned accommodation, the property features a bright and spacious reception room, a modern fitted kitchen, a generous principal bedroom with en-suite shower room, and a second double bedroom served by a contemporary family bathroom. Further benefits include lift access, ample built-in storage, access to attractive communal gardens and off street parking behind secure electrical gates.

Ideally located within easy walking distance of Willesden Green and Queen's Park, the property enjoys a fantastic selection of cafés, delis, bars and restaurants along Walm Lane and Salusbury Road. Excellent transport links are provided by Willesden Green (Jubilee Line- Zone 2) and Brondesbury Park (Mildmay- Zone 2) for easy access into Central London.

- 2 bedroom Top Floor flat in Brondesbury Park
- 831 sq ft of internal accommodation
- Lift access
- Off street parking behind secure electrical gate
- COUNCIL: Brent (E)



020 7328 2828

enquiries@cameronsstiff.co.uk
cameronsstiff.co.uk

Kingsbridge Court, Coverdale Road, London, NW2



Approximate Area = 831 sq ft / 77.2 sq m

For identification only - Not to scale

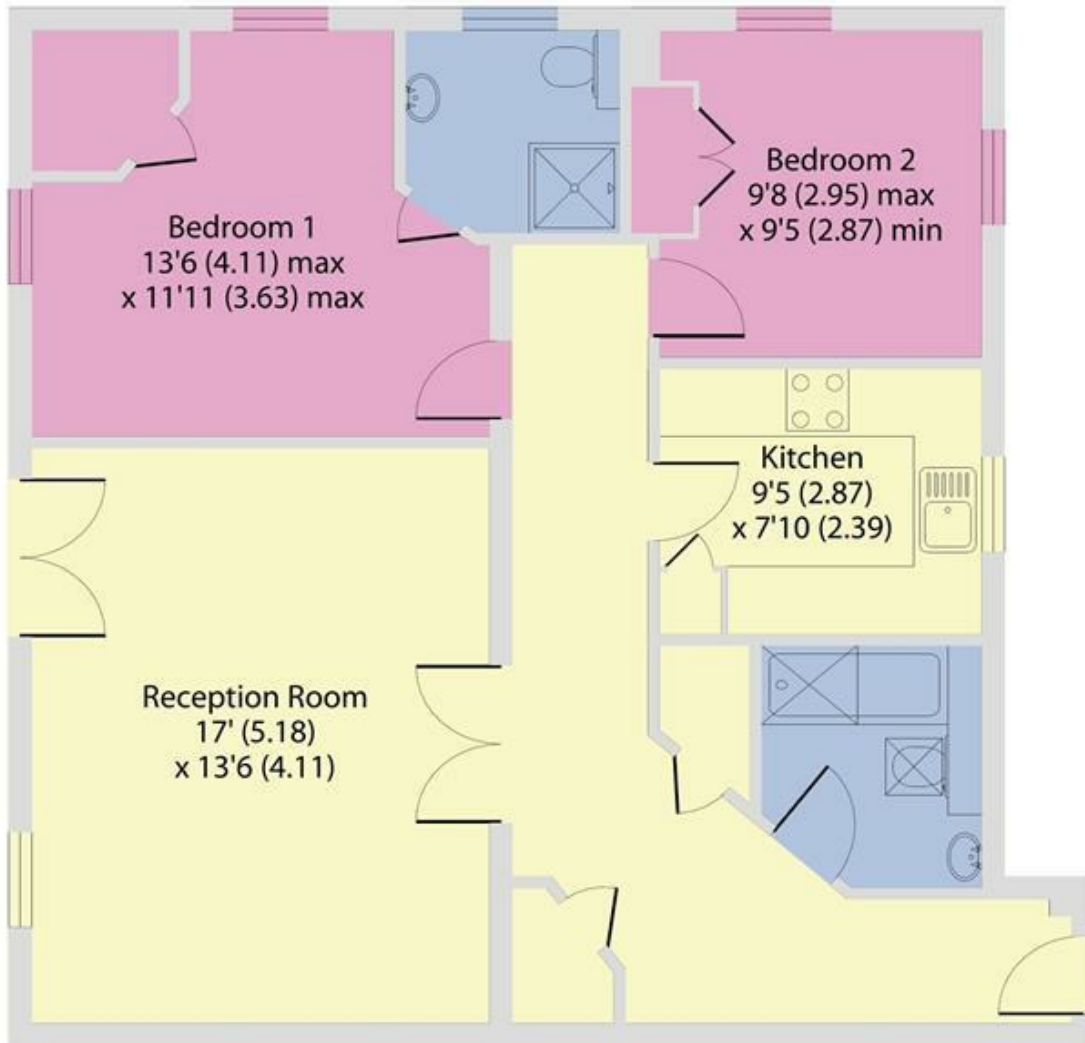

THIRD FLOOR

EPC: C

Ref: 19609567



Floor plan produced in accordance with RICS Property Measurement 2nd Edition, Incorporating International Property Measurement Standards (IPMS2 Residential). © nichecom 2025. Produced for Camerons Stiff & Co. REF: 596381

