



ANDREW  
EXELBY  
ESTATE AGENTS

## Market Square, St. Just, Penzance, TR19 7HE

£175,000

1 1 1



- FIRST FLOOR ONE BEDROOM FLAT
- IMMACULATE & NEWLY COMPLETED
- LARGE DOUBLE GLAZED SASH WINDOWS
- VIEWS OF TOWN SQUARE & CHURCH
- NO ONWARD CHAIN / CHAIN FREE
- LARGE OPEN PLAN LIVING SPACE
- DOUBLE BEDROOM WITH BUILT-IN STORAGE
- ELECTRIC CENTRAL HEATING
- EPC - TBC
- COUNCIL TAX BAND - TBC



ANDREW  
EXELBY  
ESTATE AGENTS



### Market Square, St. Just, Penzance, TR19

Approximate Area = 487 sq ft / 45.2 sq m

For identification only - Not to scale

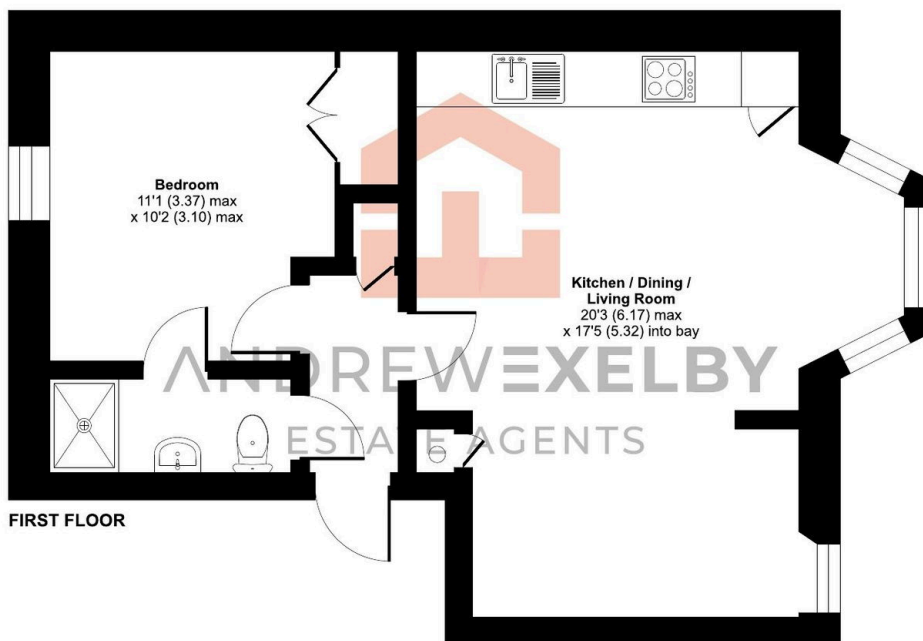

FIRST FLOOR

 Floor plan produced in accordance with RICS Property Measurement 2nd Edition, incorporating International Property Measurement Standards (IPMS2 Residential). © nichecom 2025. Produced for Andrew Exelby Estate Agents. REF: 1353274

Newly converted and recently completed to an excellent standard is this first floor one bedroom flat overlooking the town square and towards the church in St Just.