



## Clayton House, Victoria Terrace

Saltburn-By-The-Sea, TS12 1HN

**£630,000**

 19  null  null  D

Occupying an Impressive Site, a Rare and Unique Opportunity to acquire a Former Care Home or Residential Conversion Project. Offered with Immediate Vacant Possession.



Located in a Prime Position on Victoria Terrace, Clayton House is an impressive detached property, set in stunning grounds, and is located a short walk from Saltburn Town Centre and Valley Gardens. Close to all transport links and local amenities, this is an extremely rare and exciting opportunity to acquire a piece of Saltburn's unique history, and convert it into a stunning Modern Family Home.

EPC Rating - C

## Area Map



## Floor Plans

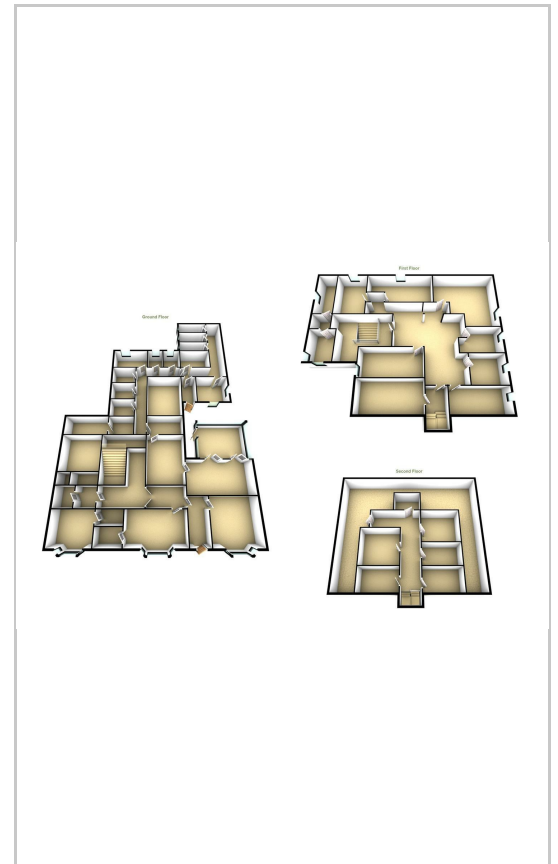

## Energy Efficiency Graph

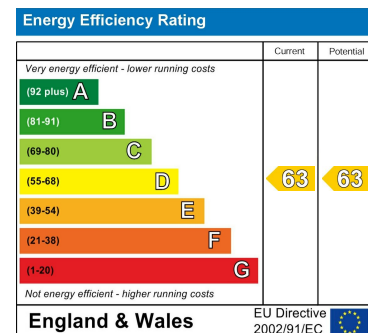

These particulars, whilst believed to be accurate are set out as a general outline only for guidance and do not constitute any part of an offer or contract. Intending purchasers should not rely on them as statements of representation of fact, but must satisfy themselves by inspection or otherwise as to their accuracy. No person in this firm's employment has the authority to make or give any representation or warranty in respect of the property.