



## Cottage Grove, KT6

£699,950

A charming Victorian cottage ideally located in the heart of Surbiton. This two double-bedroom home offers excellent potential for modernisation and features a welcoming front reception room, a rear dining area, a kitchen, and a bathroom with a separate WC. Upstairs, there are two good size bedrooms, along with additional versatile space that could be used for storage, a walk-in wardrobe, or even adapted to accommodate an upstairs bathroom.

Cottage Grove is nestled in the heart of Surbiton. The buzz of Surbiton high street and the convenience of the mainline train station and its fast train in to London Waterloo in 15 minutes, are all on your doorstep.

### Features

- Victorian Cottage
- Central Location
- Two Reception Rooms
- Two Bedrooms
- Potential To Extend (STPP)
- No Onward Chain

# Cottage Grove, Surbiton, KT6

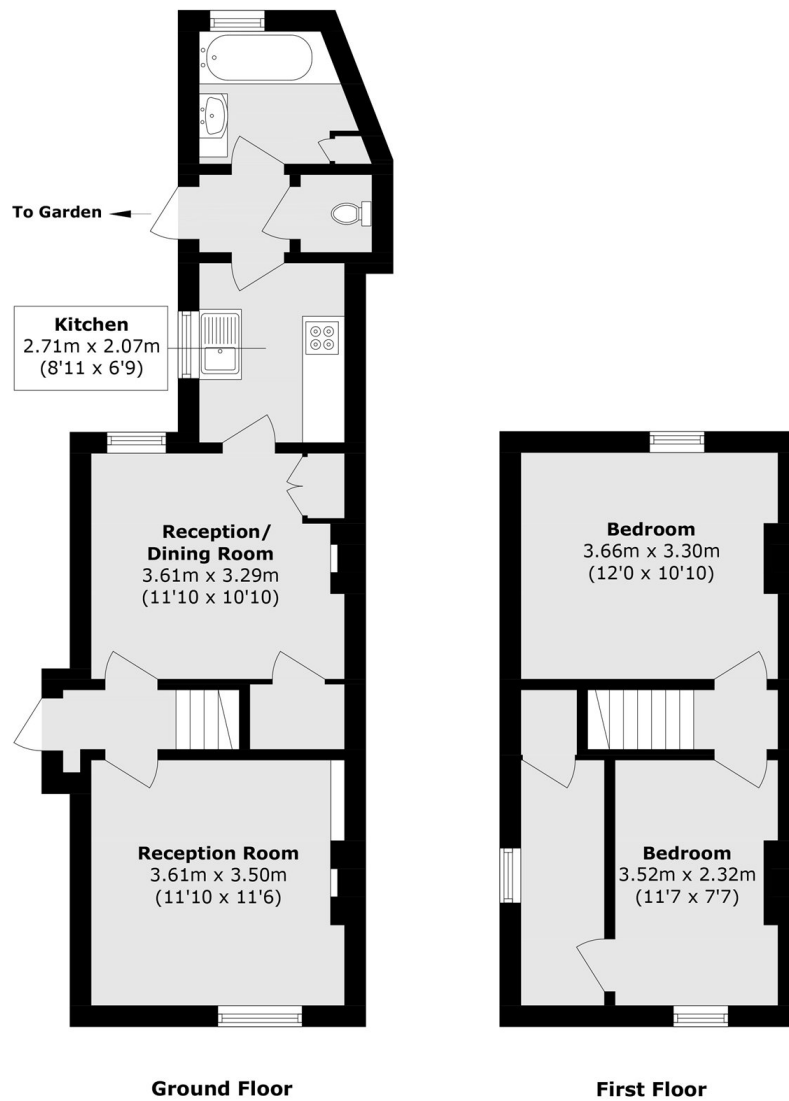

Total area (approx.): 70.6 sq. m (759.9 sq. ft)