



## PENTON RISE, LONDON, WC1X

### 2 BED APARTMENT

£450,000  
LEASEHOLD

A well-presented two-bedroom duplex apartment extending to approximately 696 sq ft, arranged across the seventh and eighth floors (with lift access) of Stelfox House on Penton Rise, WC1X. This bright and well-balanced home enjoys elevated views and an exceptionally convenient central London location.

The apartment is thoughtfully arranged over two levels, creating an excellent separation between living and sleeping accommodation. The property features a spacious reception area, a fitted kitchen and two well-proportioned bedrooms, private balcony, alongside a modern bathroom. Large windows throughout provide excellent natural light, enhancing the sense of space and openness.

The duplex layout offers a practical and versatile living environment, ideal for professionals, first-time buyers or investors seeking strong rental demand in a prime Zone 1 location.

**Hemmingfords**

## Penton Rise, WC1X 9EA

Approx Gross Internal Area = 64.7 sq m / 696 sq ft

Balcony = 2.3 sq m / 25 sq ft

Total = 67 sq m / 721 sq ft

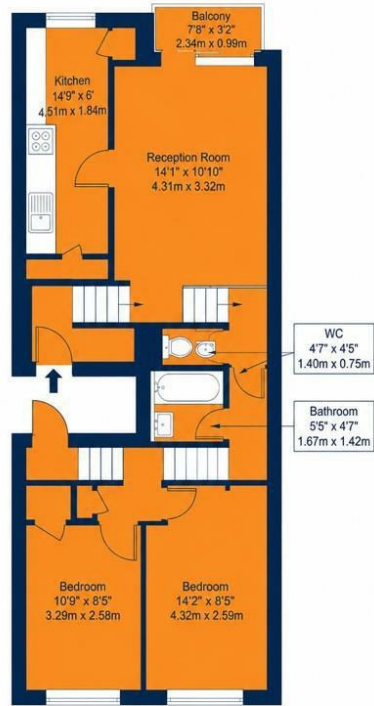

Seventh / Eighth Floor

This plan is for layout guidance only and is not to scale unless stated. All dimensions, including windows, doors, fittings, and internal area, are approximate measurements. Produced by a



Energy Efficiency Rating		Current	Potential
Very energy efficient - lower running costs			
(92 plus) A			
(81-91) B			
(69-80) C		78	83
(55-68) D			
(39-54) E			
(21-38) F			
(1-20) G			
Not energy efficient - higher running costs			
England & Wales		EU Directive 2002/91/EC	

Agents Note: Whilst every care has been taken to prepare these particulars, they are for guidance purposes only. All measurements are approximate and are for general guidance purposes only and whilst every care has been taken to ensure their accuracy, they should not be relied upon and potential buyers/tenants are advised to recheck the measurements

Hemmingfords Lettings  
34 Upper Street  
London  
N1 0PN

020 3890 7470  
info@hemmingfords.co.uk  
www.hemmingfords.co.uk

**Hemmingfords**