





## 63 Harper Close

Northwich, Northwich

Modern two-bedroom mid-terrace, close to amenities. Ideal for first-time buyers or downsizers.

Council Tax band: B

Tenure: Leasehold

EPC Energy Efficiency Rating: C

EPC Environmental Impact Rating: B

- Mid-Terraced Home
- Two Bedrooms
- Allocated Parking
- Downstairs WC
- Kitchen Diner
- Family Bathroom
- Close to Local Amenities
- LEASEHOLD

Lounge

Kitchen Diner

Downstairs WC

Landing

Master Bedroom

Bedroom Two

Bathroom











## 63 Harper Close, Winnington

### DETAILS

Total area: 645.06 sq ft  
Living area: 645.06 sq ft  
Floors: 2  
Rooms: 8

THIS FLOORPLAN IS PROVIDED WITHOUT WARRANTY OF ANY KIND. VINCENT JAMES ESTATE AGENCY DISCLAIMS ANY WARRANTY INCLUDING, WITHOUT LIMITATION, SATISFACTORY QUALITY OR ACCURACY OF DIMENSIONS.



### ▼ Ground Floor

TOTAL AREA: 357.65 sq ft • LIVING AREA:  
357.65 sq ft • ROOMS: 3

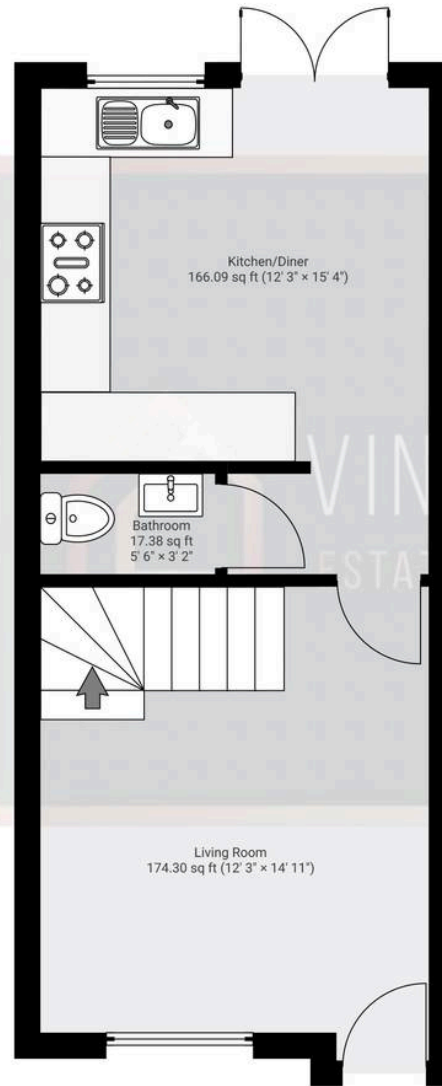

### ▼ 1st Floor

TOTAL AREA: 287.41 sq ft • LIVING AREA: 287.41 sq ft •  
ROOMS: 5

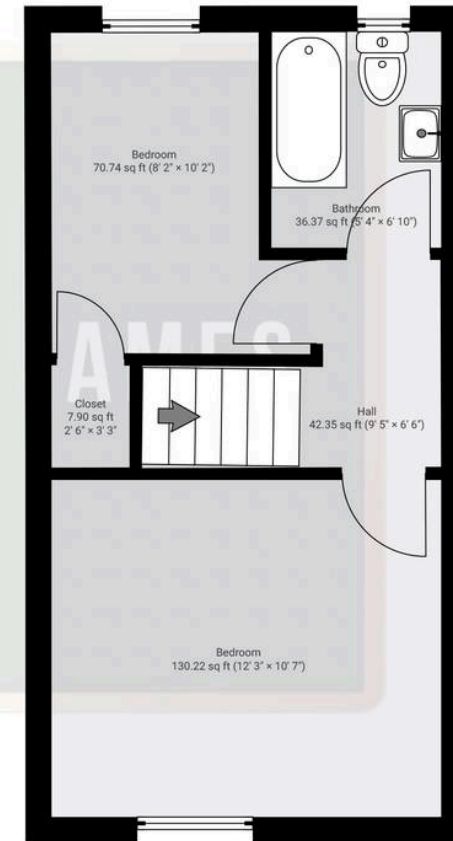

# Vincent James Estate Agents

87 Witton Street, Northwich - CW9 5DR

01606663939 • [hello@vincentjamesestateagents.co.uk](mailto:hello@vincentjamesestateagents.co.uk) • [www.vincentjamesestateagents.co.uk/](http://www.vincentjamesestateagents.co.uk/)