



3 Bed
Maisonette
located in

£2,574



TAYLOR
MICHAEL
STUDENTS

Argyle Road, Brighton, BN1 4GG

Approximate Gross Internal Area = 80.0 sq m / 861 sq ft

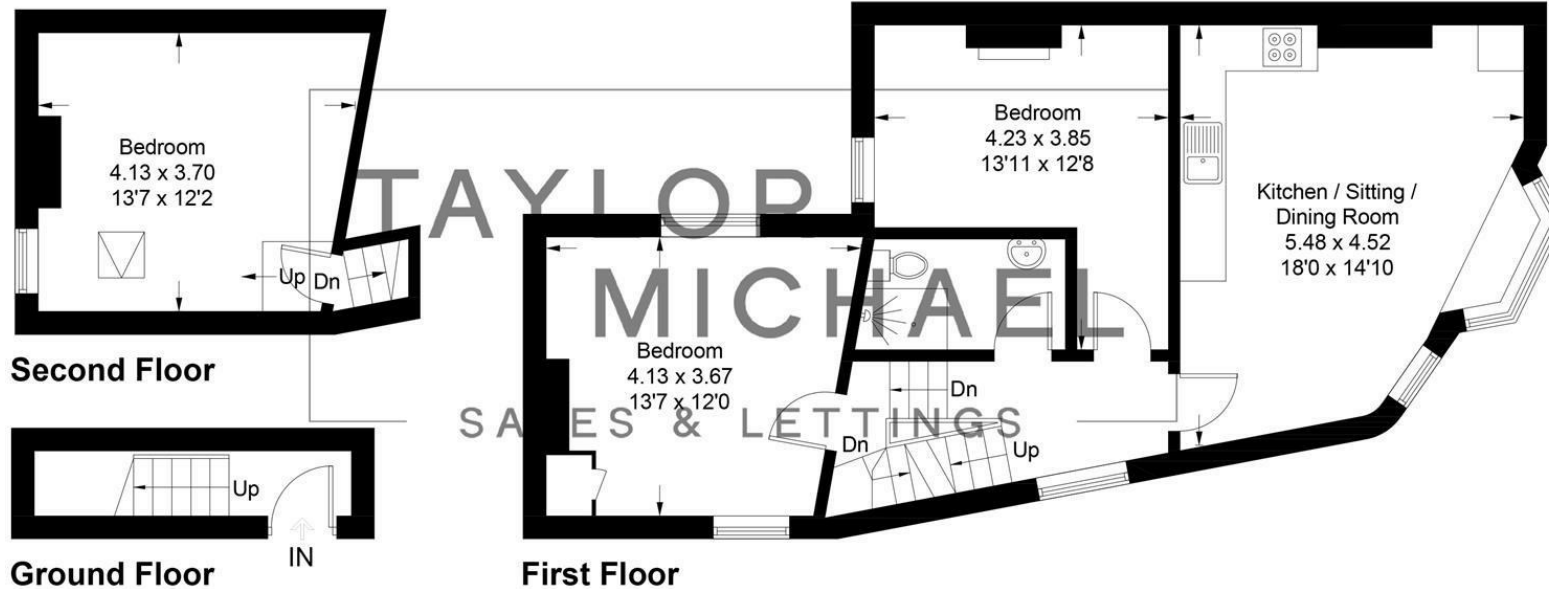
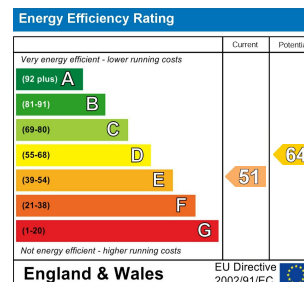

Illustration for identification purposes only, measurements are approximate, not to scale.
Imageplansurveys @ 2026



DIRECTIONS

CONTACT

62 Church Road
Hove
East Sussex
BN3 2FP

E: lettings@taylormichael.agency
T: <https://taylormichael.agency/>

**TAYLOR
MICHAEL**
STUDENTS