



# 7 Heathcote Road, Chandler's Ford, SO53 2HF

**£1,300 Per Calendar Month**

**\*ALREADY LET, NO MORE ENQUIRIES\*** A two-bed bungalow located in a quiet cul-de-sac in the centre of Chandler's Ford with off-road parking for two vehicles, side access and a separate garage. The property has been recently re-painted and re-carpeted throughout.

## ACCOMMODATION

### Entrance Hall:

Radiator x 1. Cupboard housing meters and loft hatch.

### Sitting Room:

14' x 12'9" (4.27m x 3.89m) Radiator x 1. Two windows, south facing.

### Kitchen:

9'6" x 7' (2.90m x 2.13m) Range of off-white base and wall units with a dark wood effect worktop and a stainless-steel sink with left-hand drainer. Free standing electric cooker with cooker hood over, washing machine, space and electrics for free standing fridge freezer. Larder cupboard with shelving and door to back garden.

### Bedroom 1:

11'5" x 10'9" (3.48m x 3.28) Radiator x 1. Built-in storage cupboard with shelves and hanging.

### Bedroom 2:

10'9" x 7'11" (3.28m x 2.41m) Radiator x 1. Two windows, built-in storage cupboard with shelves and hanging.

### Bathroom:

Heated towel rail. White suite with chrome fittings comprising bath with shower over and telescopic pole, WC and basin.

## OUTSIDE

### Front:

Driveway with off-road parking for two vehicles, side access, garden laid to shingle.

### Rear Garden:

Garage, lawn, mature shrubs, greenhouse.

## OTHER INFORMATION

### Approximate Age:

1950's

### Approximate Area:

53sqm/570sqft

### Management:

Tenant find only

### Furnished/Unfurnished:

Unfurnished

### Availability:

Immediately

### Security Deposit:

£1500

### Holding Deposit:

£300

### Heating:

Gas central heating

### Windows:

UPVC double glazed windows

### Infant/Junior School:

Fryern Infant/Junior School

### Secondary School:

Toynbee Secondary School

### Council Tax:

Band C

### Local Council:

Eastleigh Borough Council - 02380 688000

Ground Floor = 570 sq ft / 53 sq m  
For identification only - Not to scale

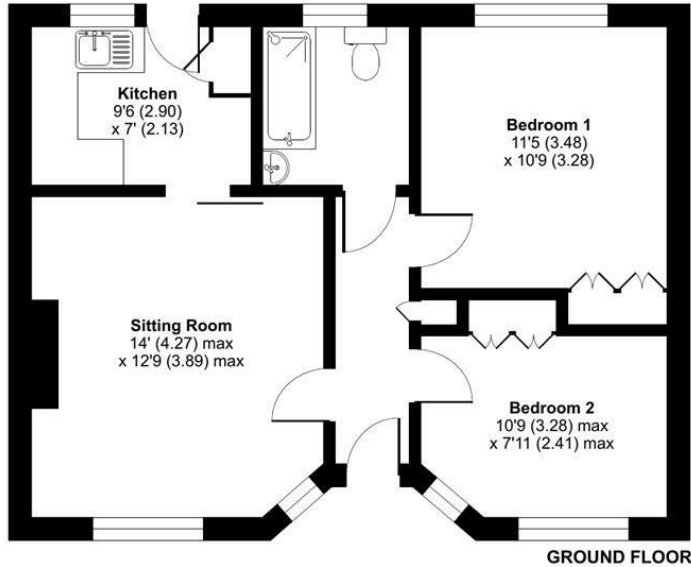

Energy Efficiency Rating		Current	Potential
Very energy efficient - lower running costs			
(92 plus) A			
(81-91) B			82
(69-80) C			
(55-68) D		62	
(39-54) E			
(21-38) F			
(1-20) G			
Not energy efficient - higher running costs			
<b>England &amp; Wales</b>		EU Directive 2002/91/EC	

Floor plan produced in accordance with RICS Property Measurement 2nd Edition, Incorporating International Property Measurement Standards (IPMS2 Residential). © ritchecom 2025. Produced for Sparks Ellison. REF: 1285196

94 Winchester Road, Chandler's Ford, Hampshire, SO53 2GJ

Sales: t: 02380 255333 e: [property@sparksellison.co.uk](mailto:property@sparksellison.co.uk)

Lettings: t: 02380 018518 e: [lettings@sparksellison.co.uk](mailto:lettings@sparksellison.co.uk)



While we endeavour to make our sales particulars fair, accurate and reliable, they are only a general guide to the property and, accordingly, if there is any point which is of particular importance to you please contact the office and we will be pleased to check it for you, especially if you are contemplating travelling some distance to view the property. These approximate room sizes are only intended as general guidance. You must verify the dimensions carefully before ordering carpets or any built in furniture. Please note we have not tested the services or any of the equipment or appliances in this property, accordingly we strongly advise prospective buyers to commission their own survey or service report before finalising their offer to purchase. These particulars are issued in good faith but do not constitute representations of fact or form part of any offer or contract. The matters referred to in these particulars should be independently verified by prospective buyers or tenants. Neither Sparks Ellison nor any of its employees or agents has any authority to make or give any representation or warranty whatever in relation to this property. Your home is at risk if you do not keep up repayments on a mortgage or other loan secured on it. Written quotations available on request. All loans secured on property. Life assurance usually required.

