

20 Field Road, King's Lynn PE30 4BE

£189,995

3 1 1



Your first home awaits! This welcoming 3-bed semi in King's Lynn is the perfect place to grow, with bright open-plan living, a generous garden, off-road parking, and three versatile bedrooms. A true blank canvas ready for your style, offered with no onward chain. Come and imagine the life you'll create here!

Key Features

- Semi-Detached House
- Ideal First Home
- No Onward Chain
- Downstairs WC
- Sought After Location - Close to Local Schools, Shops & Amenities
- 3 Bedrooms
- Off-Road Parking
- Open Plan Living/Dining Room
- Generous Rear Garden
- Council Tax Band B

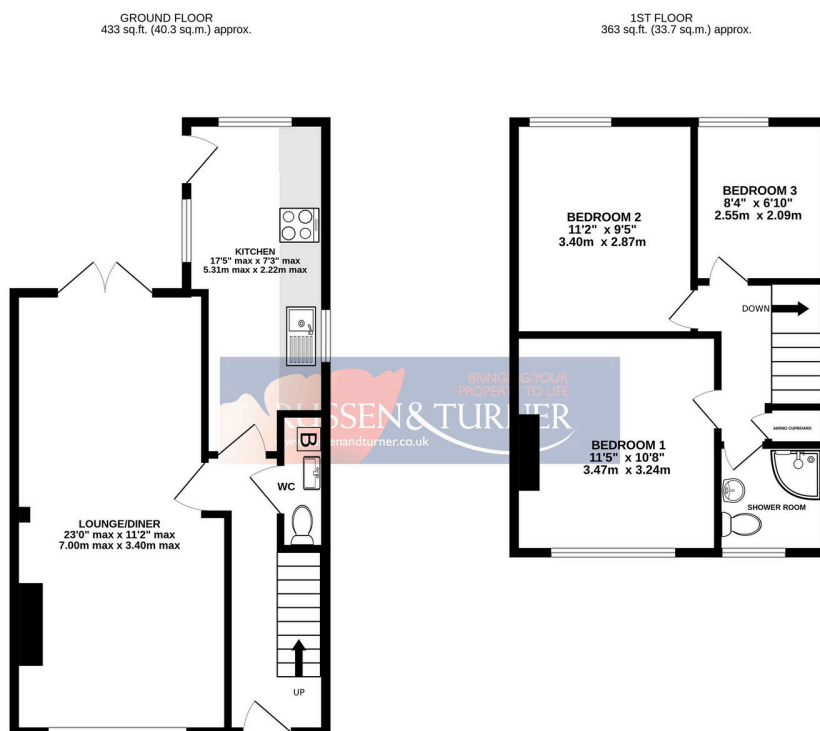

TOTAL FLOOR AREA: 796 sq ft. (73.9 sq.m.) approx.

Whilst every attempt has been made to ensure the accuracy of the floorplan contained here, measurements of doors, windows, rooms and any other items are approximate and no responsibility is taken for any error, omission or mis-statement. This plan is for illustrative purposes only and should be used as such by any prospective purchaser. The services, systems and appliances shown have not been tested and no guarantee as to their operability or efficiency can be given.
Made with Metropix ©2025