



## WHEATSHEAF LANE, SW6

£450,000

A very well-presented, bright and spacious one-bedroom flat. The property comprises a large reception room, separate modern kitchen, double bedroom and a bathroom. The kitchen and bedroom both give

One bedroom  
Private balcony

Very good condition  
No onward chain

# STEP INSIDE WHEATSHEAF LANE

## Wheatsheaf Lane, SW6

APPROX. GROSS INTERNAL FLOOR AREA  
521 SQFT / 48.4 SQM

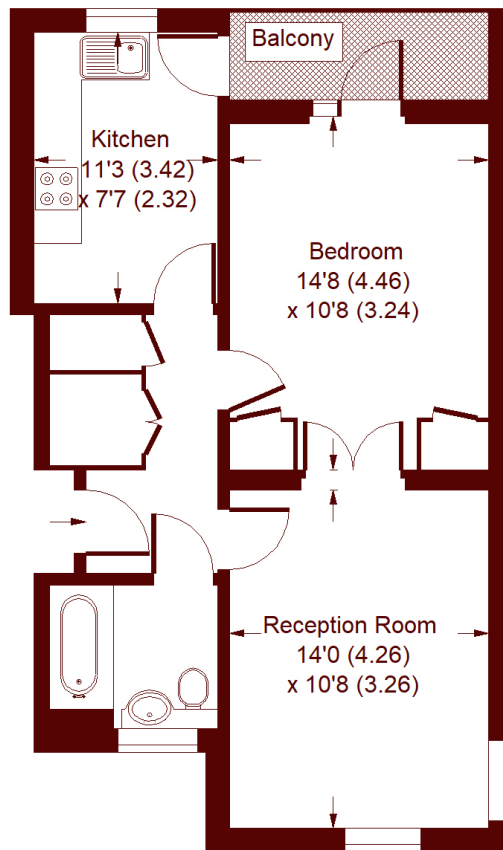

### SECOND FLOOR

Whilst every attempt has been made to ensure the accuracy of the floor plan, measurements are approximate and not to scale.  
No guarantee is given on the total square footage of the property quoted on the plan. Figures given are for guidance.  
Plan is for illustration purposes only, not to be used for valuations.

**Bishops Park**  
020 7993 9888

Energy Rating: C We aim to make our particulars both accurate and reliable. However, they are not guaranteed; nor do they form part of an offer or contract. If you require clarification on any points then please contact us, especially if you're traveling some distance to view. Please note that appliances and heating systems have not been tested and therefore no warranties can be given as to their good working order

**MARSH &  
PARSONS**