



50 Willowmead | Hertford | SG14 2AT

£1,100 pcm

A spacious one double bedroomed ground floor maisonette boasting its own private rear garden. Gas c/heating. Convenient walk to Hertford North rail station and the town centre. EPC rating D. Council tax band C. Deposit equal to one month rent.

- Large galley kitchen
- Ground floor maisonette
- One double bedroom
- Private rear garden
- Gas c/heating



Approx Gross Internal Area
42 sq m / 448 sq ft

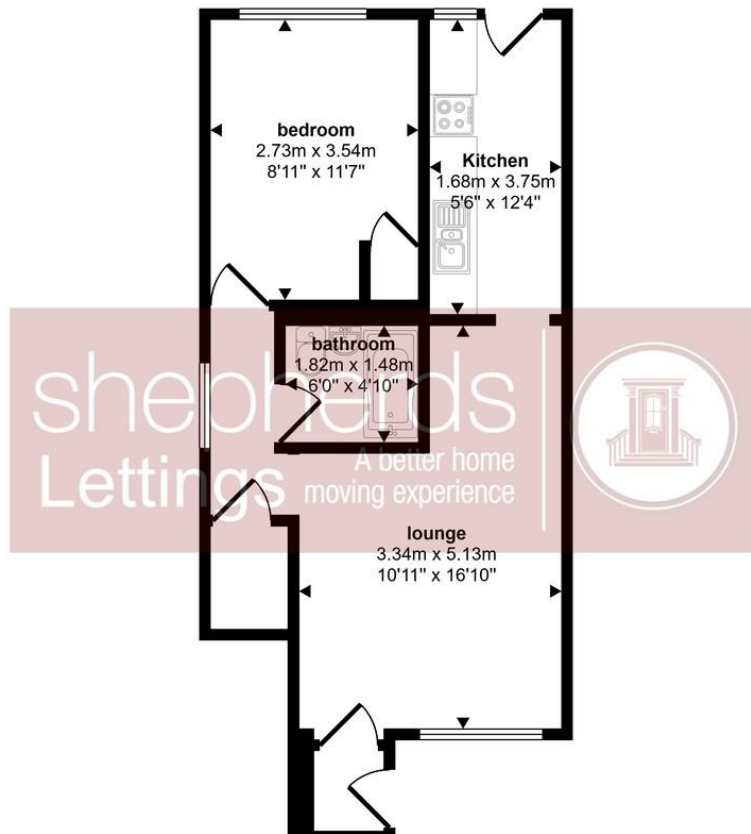

Contact Details

6 Millbridge
Hertford
Hertfordshire
SG14 1PY

www.shepherdsfhertford.com
lettings@shepherdsfhertford.co.uk
01992 551955

Score	Energy rating	Current	Potential
92+	A		
81-91	B		
69-80	C	72 C	76 C
55-68	D		
39-54	E		
21-38	F		
1-20	G		

Agents Note: Whilst every care has been taken to prepare these sales particulars, they are for guidance purposes only. All measurements are approximate are for general guidance purposes only and whilst every care has been taken to ensure their accuracy, they should not be relied upon and potential buyers are advised to recheck the measurements