



## Chiswick Village, W4

£2,300 Per calendar month

A south facing apartment located in this popular development with two bedrooms and views overlooking the well-maintained communal gardens.

Chiswick Village is within half a mile of both Kew Bridge mainline station and Gunnersbury underground station and is also close to the M4/A4.

### Features

- Two Bedrooms
- One Bathroom
- Communal Gardens
- South Facing Block
- Spacious Reception
- Transport Links

# Chiswick Village, London, W4

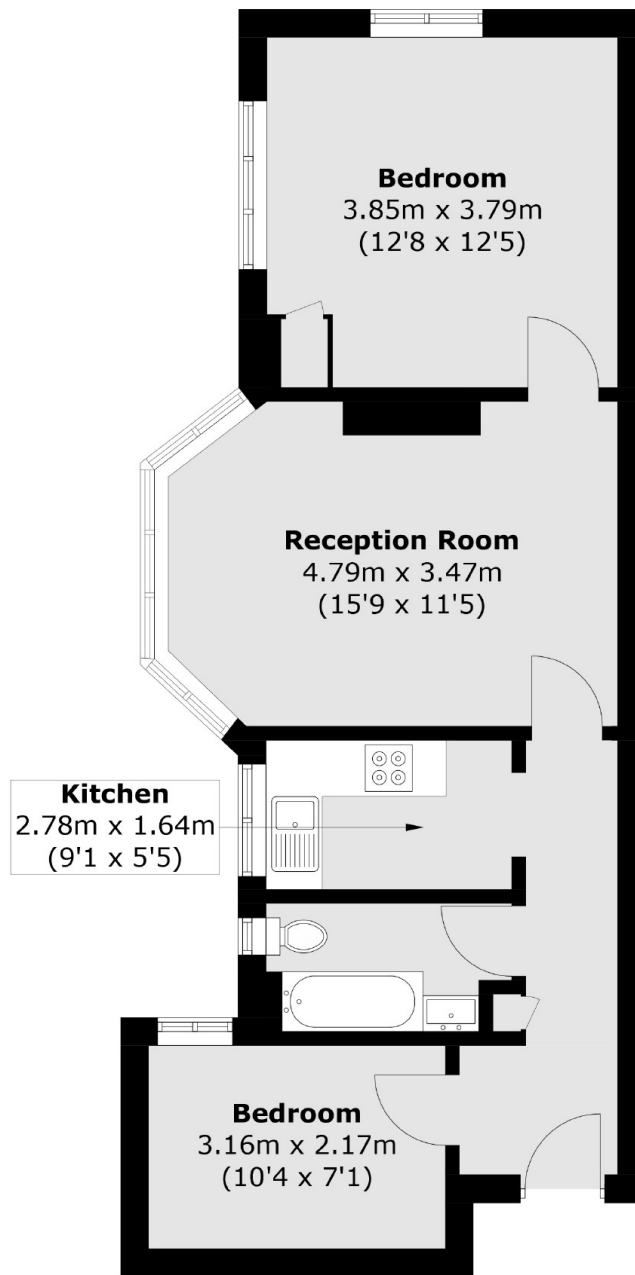

## Third Floor

Total area (approx.): 52.7 sq. m (567.3 sq. ft)