



AB Properties



114 Hawthorn Drive  
, Wishaw, ML2 8JL

Offers over £89,995



## 114 Hawthorn Drive

, Wishaw, ML2 8JL

Recently refurbished two bedroom ground floor flat situated within a popular residential area in the town centre of Wishaw.

The flat boasts generous accommodation arranged over one level comprising of a welcoming entrance hallway with storage cupboard, a spacious lounge, two double bedrooms, a modern kitchen and bathroom.

Additionally the property benefits from gas central heating and double glazing.

Externally there is a private landscaped garden to the rear which comprises of low maintenance chips and monobloc. There is also a communal drying green.

Wishaw offers an excellent range of local amenities including shops, supermarkets, cafes, leisure facilities and well-regarded schooling. The property is conveniently positioned for commuters, with easy access to the M8 and M74 motorway networks.





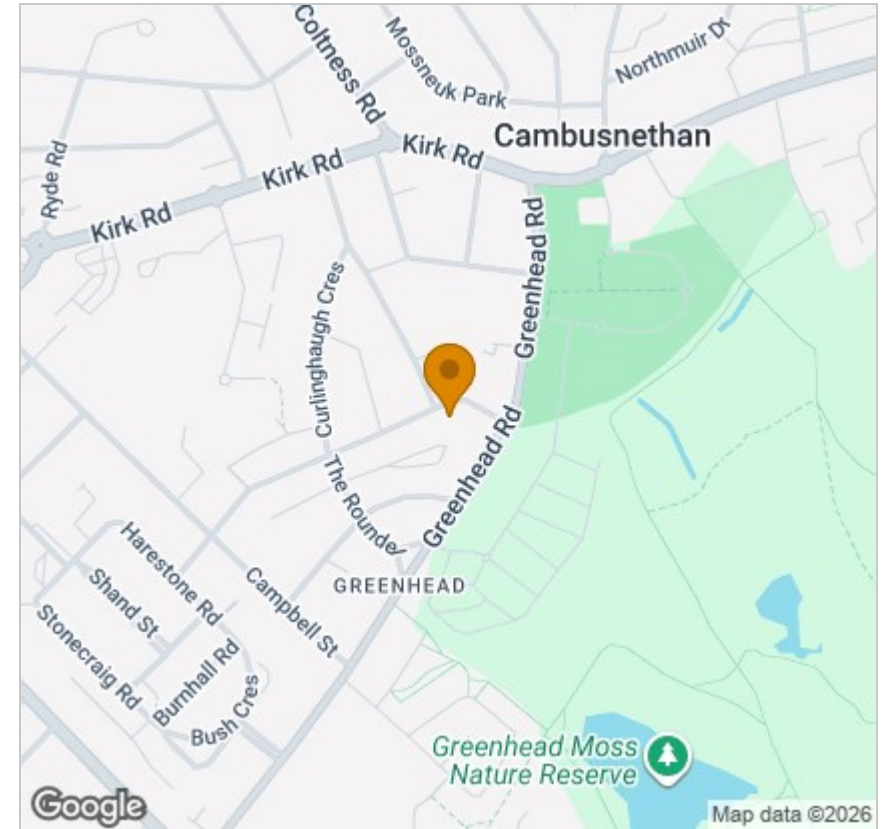
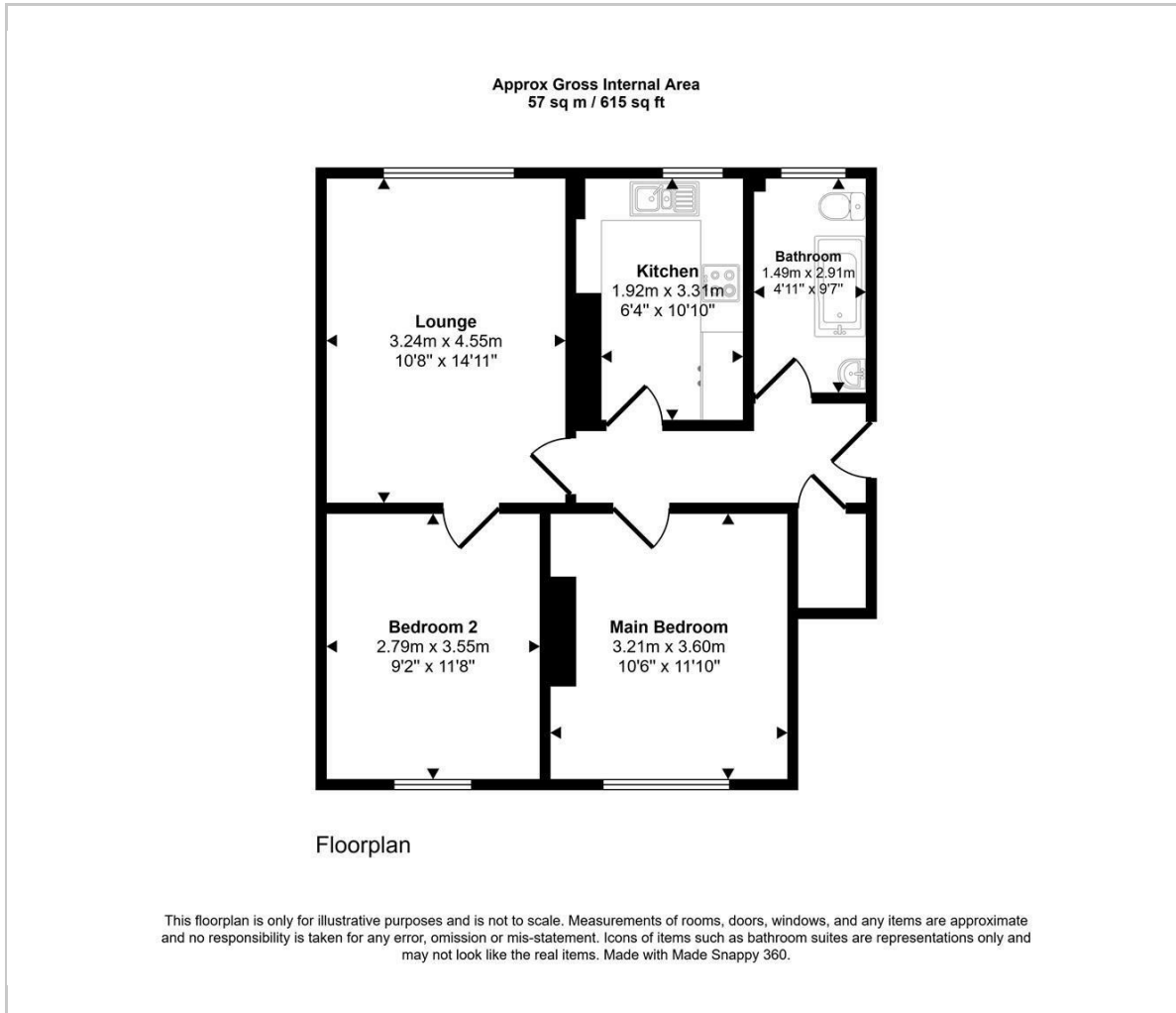

### Energy Efficiency Graph

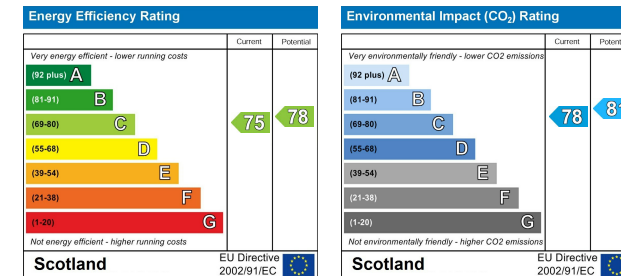

### Viewing

Please contact our AB Properties Office on 01555 660077 if you wish to arrange a viewing appointment for this property or require further information.

These particulars, whilst believed to be accurate are set out as a general outline only for guidance and do not constitute any part of an offer or contract. Intending purchasers should not rely on them as statements of representation of fact, but must satisfy themselves by inspection or otherwise as to their accuracy. No person in this firm's employment has the authority to make or give any representation or warranty in respect of the property.

19 Bannatyne Street, Lanark, Lanarkshire, ML11 7JR  
Tel: 01555 660077 Email: admin@ab-properties.co.uk ab-properties.co.uk