

STEPPING STONES

3-4 Horsefair • Banbury • Oxfordshire • OX16 0AA
Telephone: 01295 275909 • **Email:** info@steppingstonesletting.com



IVY HOUSE, SOUTH BAR STREET, BANBURY, OXON, OX16 9AF

£850pcm



A spacious one bedroom first floor apartment situated in Banbury town centre, and it is within walking distance to the train station. The property has built in storage, electric heating, a spacious living area and one allocated car parking space. EPC Rating: C. **Available: 15th July**

- 1 Bedroom
- 1 Shower room
- Electric heating
- First floor
- Close to all amenities
- Town centre location

FIRST FLOOR
458 sq.ft. (42.5 sq.m.) approx.

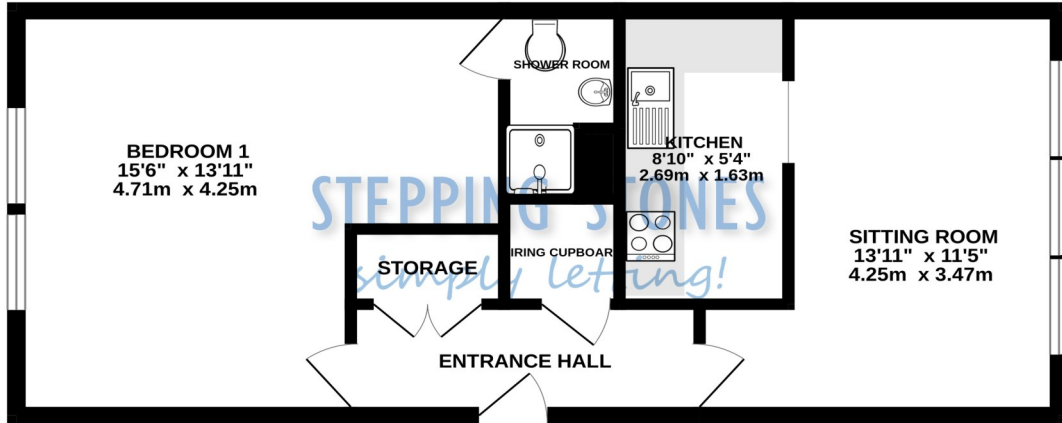

TOTAL FLOOR AREA : 458 sq.ft. (42.5 sq.m.) approx.

Whilst every attempt has been made to ensure the accuracy of the floorplan contained here, measurements of doors, windows, rooms and any other items are approximate and no responsibility is taken for any error, omission or mis-statement. This plan is for illustrative purposes only and should be used as such by any prospective purchaser. The services, systems and appliances shown have not been tested and no guarantee as to their operability or efficiency can be given.
Made with Metropix ©2026

Score	Energy rating	Current	Potential
92+	A		
81-91	B		84 B
69-80	C	72 C	
55-68	D		
39-54	E		
21-38	F		
1-20	G		

ENTRANCE HALL: Door to side aspect. Built in airing cupboard. Built in wardrobe.

BEDROOM ONE: 15'6 x 13'11 Windows to rear aspect. Through to:

SHOWER ROOM: White suite comprising low level w.c., wash hand basin and shower cubicle.

SITTING ROOM: 13'11 x 11'5 Windows to front aspect. Through to:

KITCHEN: 8'10 x 5'4 Floor fitted and wall mounted units with worktops over, four ring electric hob with oven below and extractor hood above.

HEATING: Electric heating

PARKING: One allocated car parking space

COUNCIL TAX: Band A

EPC RATING: C

REFERENCE: 319

RENT: £ 850.00
TOTAL DEPOSIT: £ 980.76
HOLDING DEPOSIT: £ 196.15

Holding deposit is payable when the application is made and is deducted from the initial rent if the application is successful.

Please Note: This is **non-refundable** should any relevant person (including any guarantor(s)) withdraw from the tenancy, fail a Right-to-Rent check, provide materially significant false or misleading information, or fail to sign their tenancy agreement (and / or Deed of Guarantee) within 15 calendar days (or other Deadline for Agreement as mutually agreed in writing).

Important Notice

Every care has been taken with the preparation of these particulars but they are for general guidance only and complete accuracy cannot be guaranteed. If there is any point which is of particular importance then professional verification should be sought. These particulars do not constitute part, or all of, an offer or contract and are not to be relied upon as statement of representation or fact. Stepping Stones have not carried out a structural survey and the services, appliances, equipment, fixtures and fittings have not been tested and no guarantees as to their operating ability or efficiency are given. The measurements and floorplans supplied are for general guidance only and are not to scale. All dimensions and compass positions are approximate and for guidance only and should not be relied upon. Photographs are reproduced for general information and it cannot be inferred that any item shown is included in the letting.

