

Stockport Road, Denton, Manchester, M34 6AX

Offers Over £170,000

2 1 2



- Please Quote Ref SB1444
- Two Double Bedrooms
- Two Reception Rooms
- No Onwards Chain
- Excellent Transport Links
- Walking Distance Outstanding Local Schools
- Walking Distance To Crown Point North
- M60 Ring Road Close By
-
-

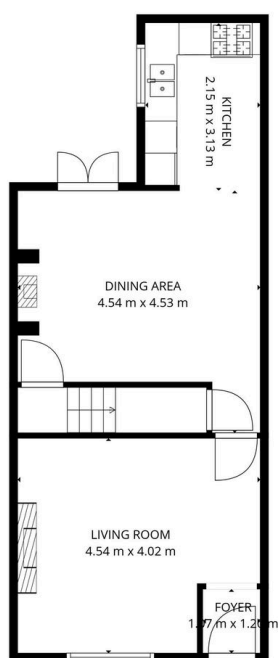

1st Floor



1st floor

TOTAL: 92 m2

1st Floor: 46 m2, 1st floor: 46 m2
EXCLUDED AREAS: WALLS: 10 m2

FLOOR PLAN CREATED BY CUBICSA APP. MEASUREMENTS DEEMED HIGHLY RELIABLE BUT NOT GUARANTEED.

Open Day Saturday 29th November. Call To Book Your Time Slot.

Welcome To Stockport Road, Denton. A Spacious Two Double Bedroom Mid Terrace Period Home To Make Your Very Own.