



Oakwood Avenue, Gatley

Guide Price £750,000

🛏 4 🚿 1 🛋 3

- Detached Family Home.
- Double Garage.
- Four Bedrooms.
- Central Gatley Location.
- No Onward Chain.
- Large Corner Garden Plot.
- Period Features Throughout.
- Three Large Reception Rooms.
- Extensive Off Road Parking.
- Viewing By Appointment.



A most elegant EXTENDED DETACHED RESIDENCE situated in the HEART OF GATLEY VILLAGE, boasting one of Gatleys most ENVIABLE GARDEN PLOTS AND OFFERED FOR SALE WITH NO ONWARD CHAIN. The accommodation comprises of a central entrance hallway with cloaks and shower room opening to a sitting room, dining room and principal living room and a fitted large kitchen. The upper floors reveal four excellent double bedrooms served by large family bathroom with separate W.C. Externally, the property boasts a large frontage with driveway leading to a double garage. To the side and rear are extensive lawn gardens with a number of flagged patio areas.



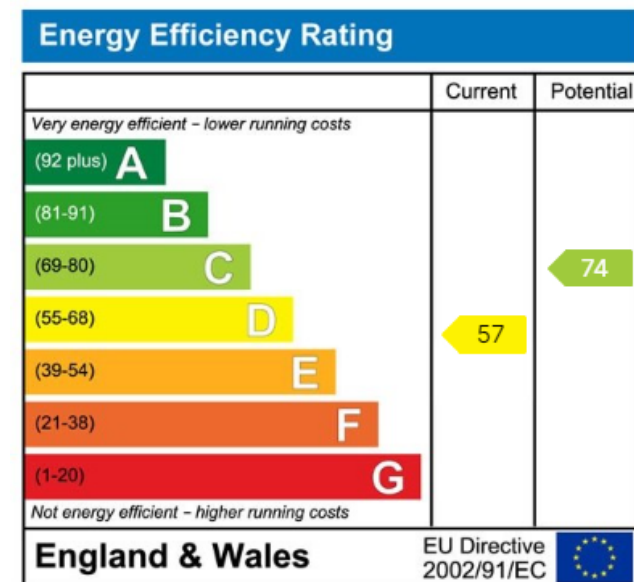
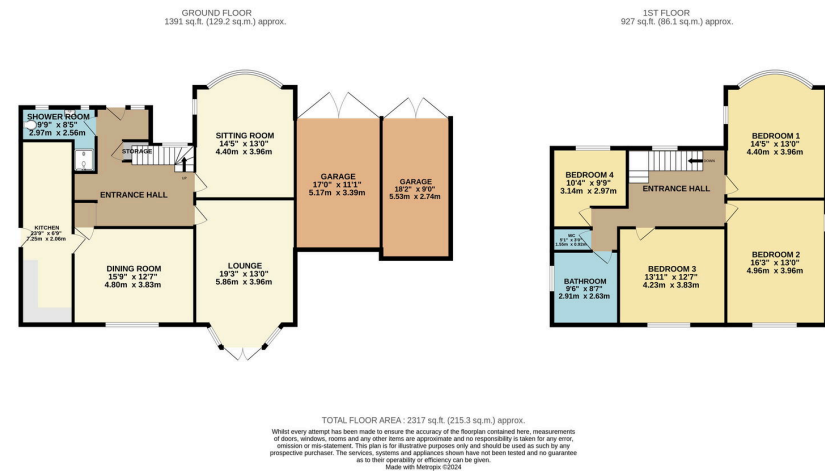

9 Gatley Road, Cheadle, Cheshire SK8 1LY Tel. 0161 428 1488 Fax. 0161 428 1479
 Email. mail@andrewdawson.co.uk