



**CHURCH ROAD HOVE BN3**  
**£1,850 PER MONTH** AVAILABLE 16/06/2026

**Hamptons**

THE HOME EXPERTS

# { THE PARTICULARS

Church Road Hove BN3

£1,850 Per Month  
Unfurnished

 2 Bedrooms  
 1 Bathroom  
 1 Reception

## Features

- Recently Refurbished, - Approx 900 Sq.  
Ft., - Parking Permit Zone N, - Sea Views, -  
Council Tax Band B

## Council Tax

Council Tax Band B

Hamptons  
54 Church Road  
Hove, BN3 2FN  
01273 737 777  
[brightonandhovelettings@hamptons.co.uk](mailto:brightonandhovelettings@hamptons.co.uk)  
[www.hamptons.co.uk](http://www.hamptons.co.uk)

# { A BEAUTIFULLY REFURBISHED TWO-BEDROOM FIRST FLOOR FLAT

## The Property

Welcome to this beautifully refurbished two-bedroom first floor flat located in the heart of Central Hove. This apartment features a super wide entrance hallway that creates an immediate sense of space and elegance as you step inside. At the front of the apartment is a lovely living room with feature fireplace and oversized bay window (with seating area) offering views along Medina Villas and out to sea. The modern separate kitchen is equipped with sleek cabinetry and integrated appliances include a fridge freezer, dishwasher, washing machine, tumble dryer and electric oven and hob. The principal bedroom is a generous size with a feature fireplace and the second bedroom is a smaller double room. The stylish bathroom includes elegant fixtures and a shower over the bath plus there is a separate cloakroom. Newly installed flooring throughout, double glazing, and efficient heating systems ensure year-round comfort and energy efficiency. Situated in a prime location, you'll enjoy easy access to a variety of shops, cafes, restaurants, local parks & cultural attractions making it an ideal home for professional couples. We understand that mains services are connected for Gas, Electric & Water.



# Church Road, Hove, BN3

Approximate Area = 900 sq ft / 83.6 sq m

For identification only - Not to scale

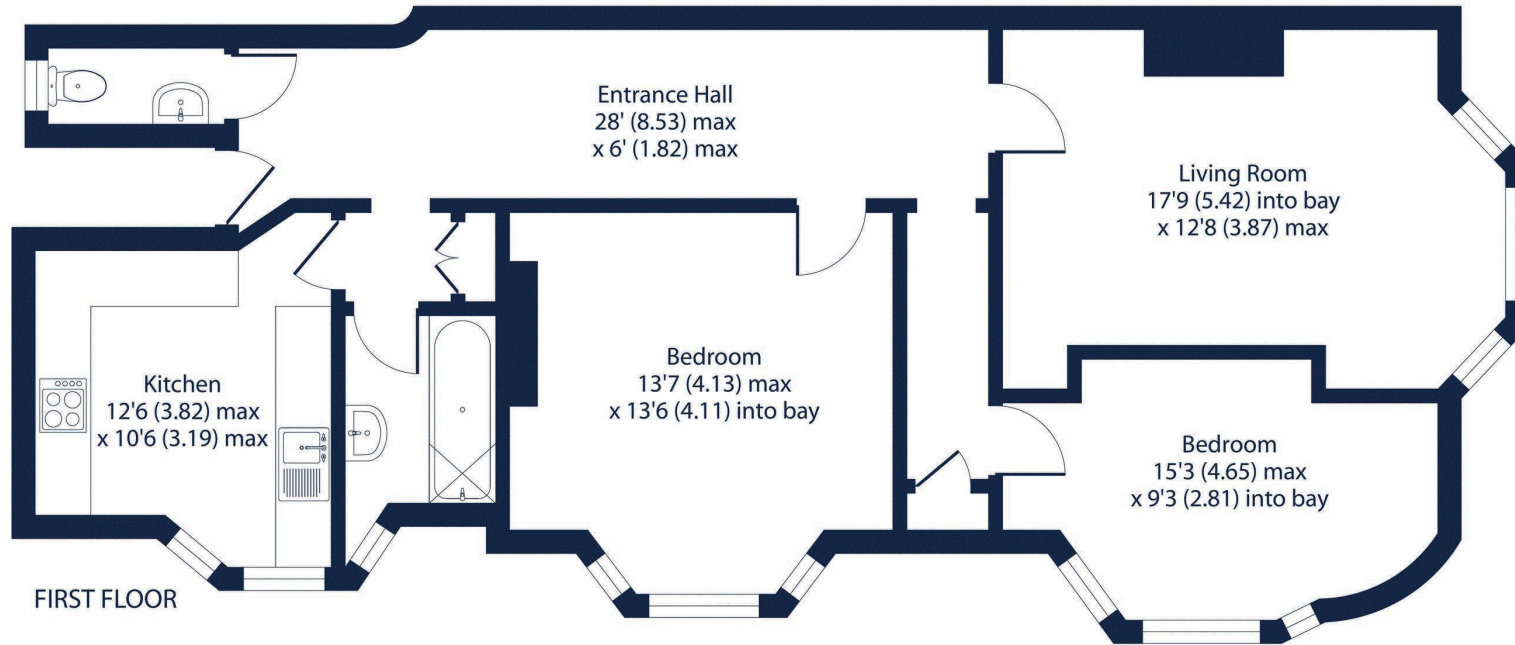

Floor plan produced in accordance with RICS Property Measurement 2nd Edition, Incorporating International Property Measurement Standards (IPMS2 Residential). © n'checom 2025. Produced for Hamptons. REF: 1287873

## For Clarification

We wish to inform prospective tenants that we have prepared these particulars as a general guide and they have been confirmed as accurate by the landlord. We have not verified permissions, nor carried out a survey, tested the services, appliances and specific fittings. Room sizes are approximate and measurement figures rounded: they are taken between internal wall surfaces and therefore include cupboards/shelves, etc. Accordingly, they should not be relied upon for

carpets and furnishings. It should also be noted that all fixtures and fittings, carpeted, curtains/blinds, kitchen equipment and garden statuary, whether fitted or not, are deemed removable by the landlord unless specifically itemised with these particulars. Please enquire in office or on our website for details on holding deposit and tenancy deposit figures.

Energy Efficiency Rating		Current	Potential
Very energy efficient - lower running costs	A		
	B		
	C		
	D	70	74
	E		
	F		
Not energy efficient - higher running costs	G		

England & Wales EU Directive 2002/91/EC



ESTABLISHED 1869  
h  
THE HOME EXPERTS