



New Cross Road, SE14

£795,000

This stunning Grade II Listed Regency duplex apartment spans over 1,206 sq ft, sensitively renovated to a high specification with an exceptional blend of period and modern features. Exceptionally bright throughout, the apartment enjoys a large shared front garden with mature planting that creates a peaceful buffer from the road, alongside its own private, enclosed rear garden - secluded, not overlooked, and a rare find in the capital.

New Cross Road is in the heart of the local area with a buzzing parade of thriving independent shops, bars and restaurants. Numerous transport connections can be found on your doorstep with both New Cross Gate and Queens Road providing quick and frequent mainline links to London Bridge, Blackfriars and the City.

Features

Regency Apartment
Three Bedroom Two Bathroom
Grade Two Listed
Stunning Duplexes
Private Garden
Close To New Cross Gate

New Cross Road, London, SE14

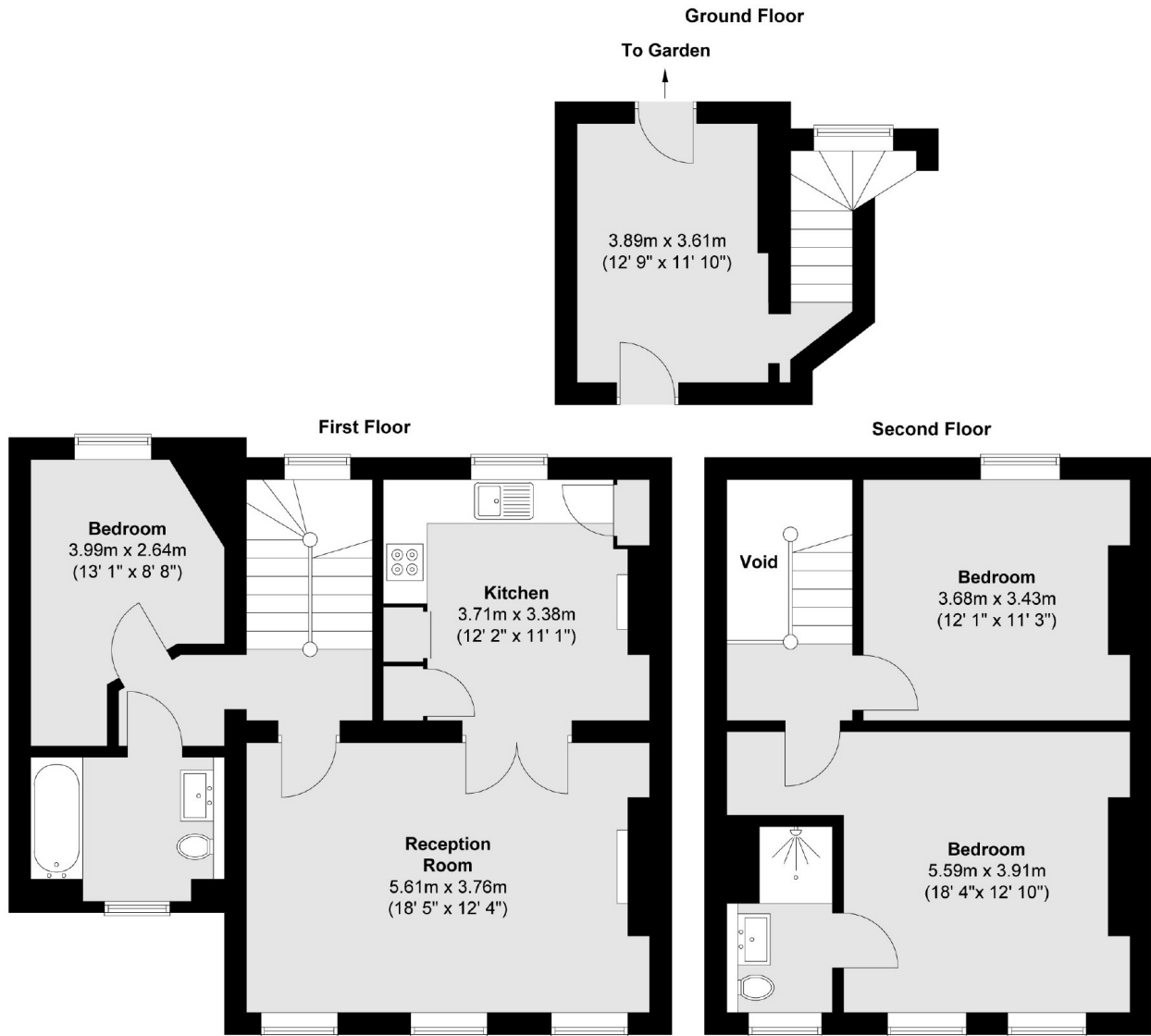

Total area (approx.): 112 sq. m (1206 sq. ft)