



**POOLE  
TOWNSEND**

# Kent Street, Barrow-in-furness, LA13 9QP

£95,000

🛏️ 2 🚿 1 🚗 2



- 2 Bed End Of Terrace Property
- Ideal For First Time Buyers And Investors
- Modern Fitted Kitchen
- Rear Yard With Storage Shed
- Gas Fired Central Heating
- Located In A Popular Residential Area
- Two Reception Rooms
- Two Bedrooms
- UPVC Double Glazing
- Council Tax Band - A



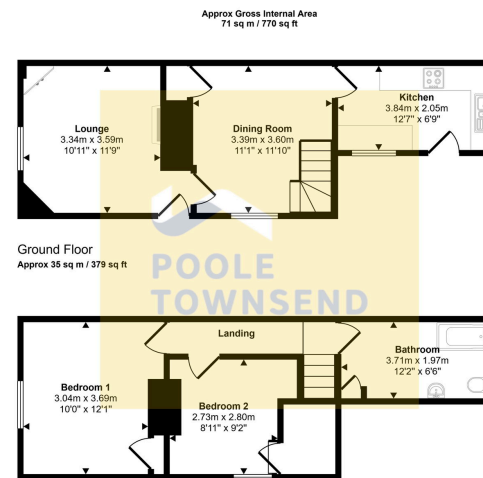

This floorplan is only for illustrative purposes and is not to scale. Measurements of rooms, doors, windows, and any items are approximate and no responsibility is taken for any error, omission or mis-statement. Icons of items such as bathroom suites are representations only and may not look like the real items. Made with Made Snappy 360.

**NEW!** Situated in a popular residential area close to schools, local amenities, Aldi supermarket, regular bus services, the town's leisure centre and park, this well-presented end-terrace home is ideal for first-time buyers and investors alike. The property offers two reception rooms, including a cosy lounge with a solid fuel stove and a separate dining room leading to a bright, modern fitted kitchen with integrated oven, gas hob and space for additional appliances. Upstairs are two bedrooms, a family bathroom and loft access, while outside there is an enclosed rear yard with a useful storage shed. Further benefits include uPVC double glazing, a composite front door and gas-fired central heating, making this an attractive and conveniently located home ready to move into.

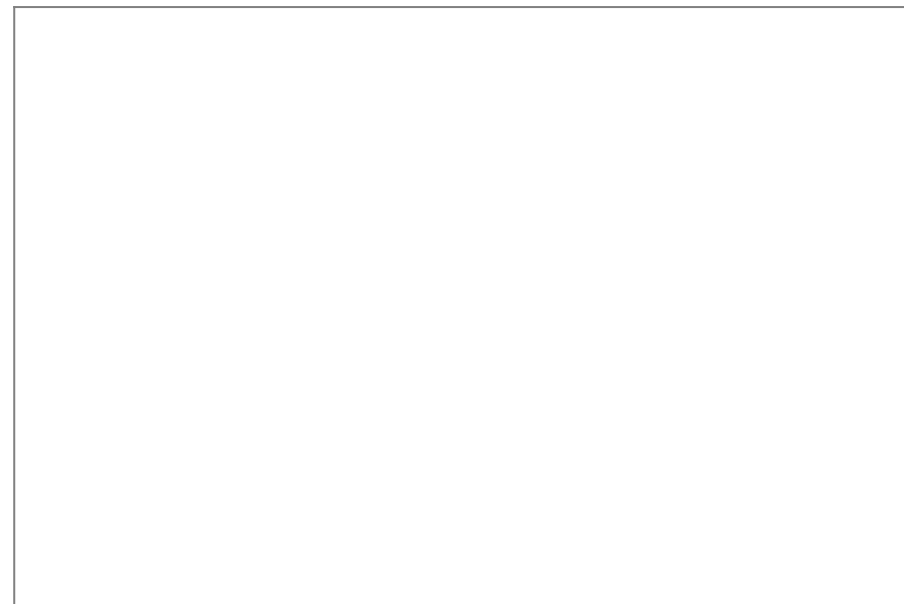

Visit us at  
[www.pooletownsend.co.uk](http://www.pooletownsend.co.uk)  
[enquiries@pooletownsend.co.uk](mailto:enquiries@pooletownsend.co.uk)

We are open  
 Monday – Friday 9.00 – 5.00  
 Saturday 9.00 – 1.00

Barrow 01229 811811  
 Ulverston 01229 588111  
 Grange 015395 33316  
 Kendal 01539 734455  
 Milnthorpe 015395 62044