



## Malden Road, NW5

£519 Per week

At approximately 581 sq ft is this one double bedroom, one bathroom period apartment with its own private entrance. The apartment has a separate kitchen, a large reception room and a private courtyard.

Malden Road is conveniently located within easy reach of Kentish Town, Chalk Farm, Gospel Oak and is only a short distance to Hampstead Heath. Belsize Park underground is within a mile.

### Features

- One Double Bedroom
- One Bathroom
- Chain Free
- Private Entrance
- Share Of Freehold
- Private Courtyard

# Malden Road, London, NW5

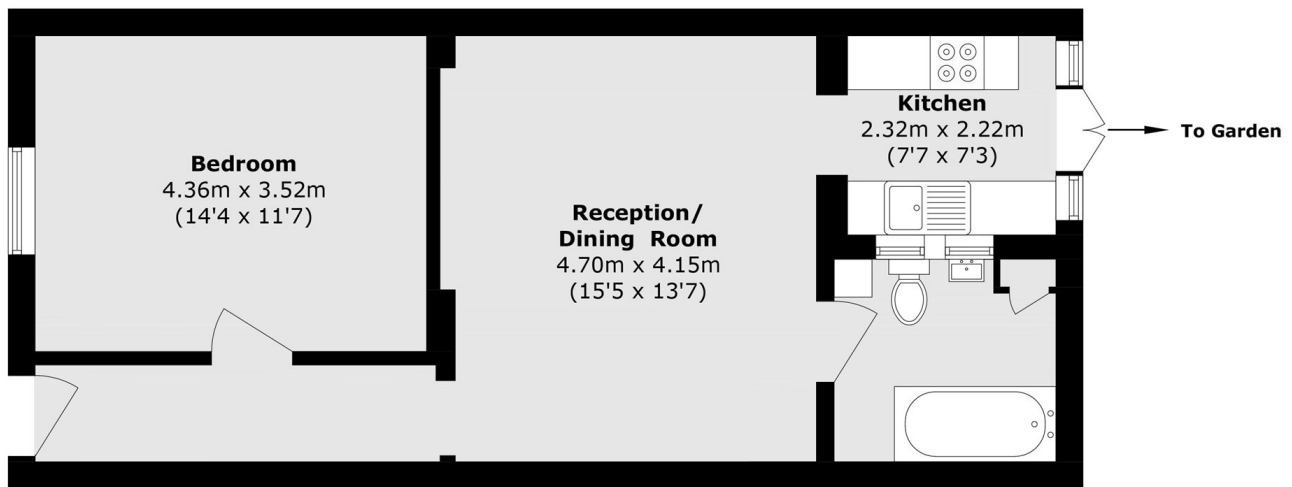

Total area (approx.): 54.0 sq. m (581.2 sq. ft)