



**Hernefield Road, Birmingham B34 6PG**



**welcome to**

**Hernefield Road, Birmingham**

**\*\*MID-TERRACE PROPERTY\*\*TWO BEDROOMS\*\*LOUNGE DINER\*\*FITTED KITCHEN\*\*UPSTAIRS BATHROOM\*\*COVERED SIDE ACCESS\*\*FRONT AND REAR GARDENS\*\*IDEAL FOR FIRST TIME BUYERS\*\***



## Agents Note

This House is a Wimpey No Fine.

## Entrance Hall

Radiator, ceiling light point, laminate flooring and stairs to first floor.

## Lounge

Double glazed window to front, radiator, two ceiling light points, coving, feature gas fire fireplace

## Kitchen

Double glazed window to rear, cupboards and base units, roll top work surface, one and half bowl stainless steel sink and drainer, hob and oven, plumbing for washing machine, tiled floor, half tiled walls, side door to covered access.

## Side Covered Access

Covered access to the side with door to front, brick build shed and

## Landing

Loft access with and ceiling light point.

## Bedroom One

Double glazed window to front, radiator and built in cupboard.

## Bedroom Two

Double glazed window to rear, two built in cupboards and ceiling light point.

## Bathroom

Double glazed window to rear, radiator, ceiling light point, bath, half tiled walls, laminate flooring, low level w.c., and pedestal basin.

## Garden

Gravelled patio, mainly lawned, shrubs and trees, brick shed enclosed by fencing.

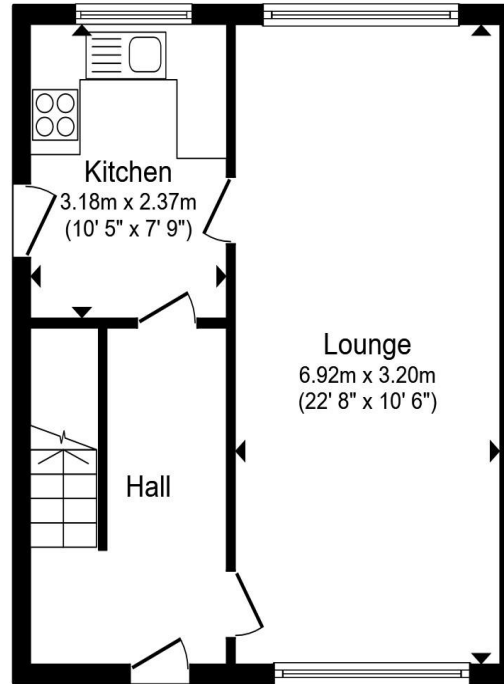

Ground Floor

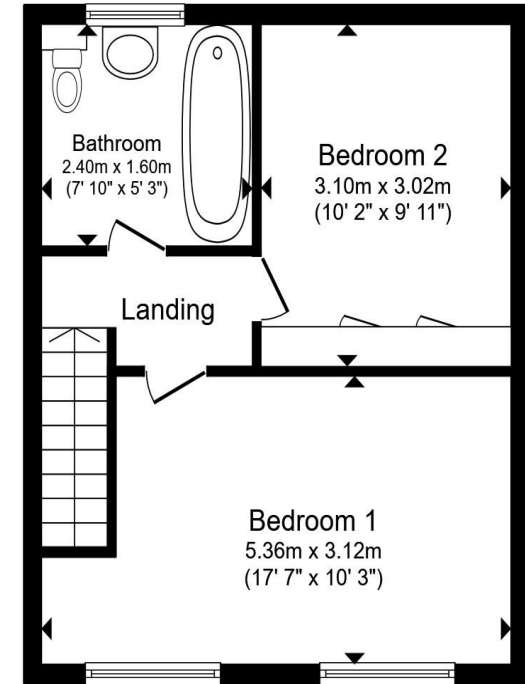

First Floor

Total floor area 78.5 m<sup>2</sup> (845 sq.ft.) approx

This floor plan is for illustrative purposes only. It is not drawn to scale. Any measurements, floor areas (including any total floor area), openings and orientation are approximate. No details are guaranteed, they cannot be relied upon for any purpose and they do not form part of any agreement. No liability is taken for any error, omission or misstatement. A party must rely upon its own inspection(s). Powered by [www.propertybox.io](http://www.propertybox.io)



**view this property online** [shipways.co.uk/Property/CAB111761](http://shipways.co.uk/Property/CAB111761)



welcome to

## Hernefield Road, Birmingham

- IDEAL FOR FIRST TIME BUYERS
- MID TERRACE
- TWO BEDROOMS
- LOUNGE DINER
- FITTED KITCHEN

Tenure: Freehold EPC Rating: C  
Council Tax Band: B

offers over  
**£210,000**



Please note the marker reflects the  
postcode not the actual property

view this property online [shipways.co.uk/Property/CAB111761](https://shipways.co.uk/Property/CAB111761)



Property Ref:  
CAB111761 - 0005

1. MONEY LAUNDERING REGULATIONS Intending purchasers will be asked to produce identification documentation at a later stage and we would ask for your co-operation in order that there is no delay in agreeing the sale. 2. These particulars do not constitute part or all of an offer or contract. 3. The measurements indicated are supplied for guidance only and as such must be considered incorrect. Potential buyers are advised to recheck measurements before committing to any expense. 4. We have not tested any apparatus, equipment, fixtures or services and it is in the buyers interest to check the working condition of any appliances. 5. Where an EPC, or a Home Report (Scotland only) is held for this property, it is available for inspection at the branch by appointment. If you require a printed version of a Home Report, you will need to pay a reasonable production charge reflecting printing and other costs. 6. We are not able to offer an opinion either written or verbal on the content of these reports and this must be obtained from your legal representative. 7. Whilst we take care in preparing these reports, a buyer should ensure that his/her legal representative confirms as soon as possible all matters relating to title including the extent and boundaries of the property and other important matters before exchange of contracts.

Shipways is a trading name of Sequence (UK) Limited which is registered in England and Wales under company number 4268443, Registered Office is Cumbria House, 16-20 Hockliffe Street, Leighton Buzzard, Bedfordshire, LU7 1GN. VAT Registration Number is 500 2481 05.

shipways



**0121 747 4722**



castlebromwich@shipways.co.uk



258 Chester Road, Castle Bromwich,  
BIRMINGHAM, West Midlands, B36 0JE



**shipways.co.uk**