



Cromwell Road, SW7

£520 Per week

A contemporary and generously proportioned studio apartment situated on the third floor of a secure, portered building, featuring private outdoor space and located in the South Kensington area.

The apartment is situated within a well-regarded development that offers a 24-hour concierge service and is conveniently located near the Underground station, as well as the amenities of South Kensington and Gloucester Road.

Features

- Spacious Studio
- Third Floor
- Lift Access
- Wooden Flooring
- Contemporary Bathroom
- Private Balcony
- 24-hour Porter

Cromwell Road, London, SW7

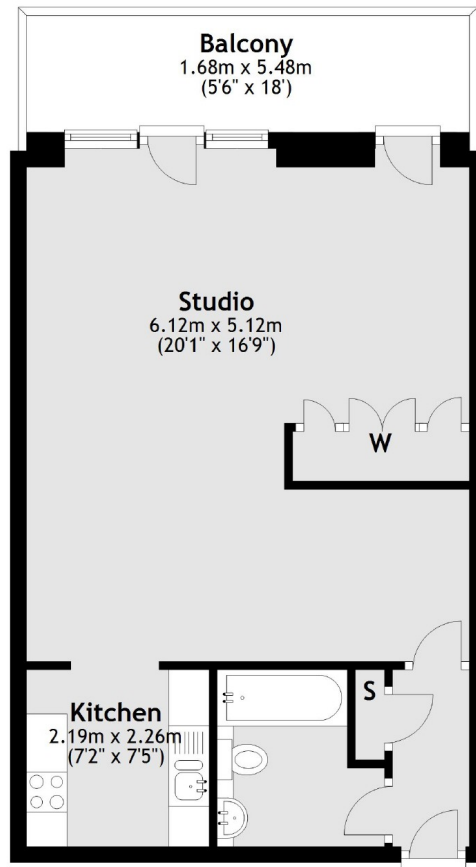

Third Floor

Total area: approx. 46.9 sq. metres (504.9 sq. feet)