

3 Bed House - Detached
located in

JR

JOSHUA REED
Estate Agents

10 Post Wood Road
Ware
SG12 9NJ



Guide price £700,000

CONTACT

23-27 Maidenhead Street
Hertford
Hertfordshire
SG14 1DW

EMAIL

josh@joshua-reed.co.uk

TELEPHONE

01992 917388

www.joshua-reed.co.uk

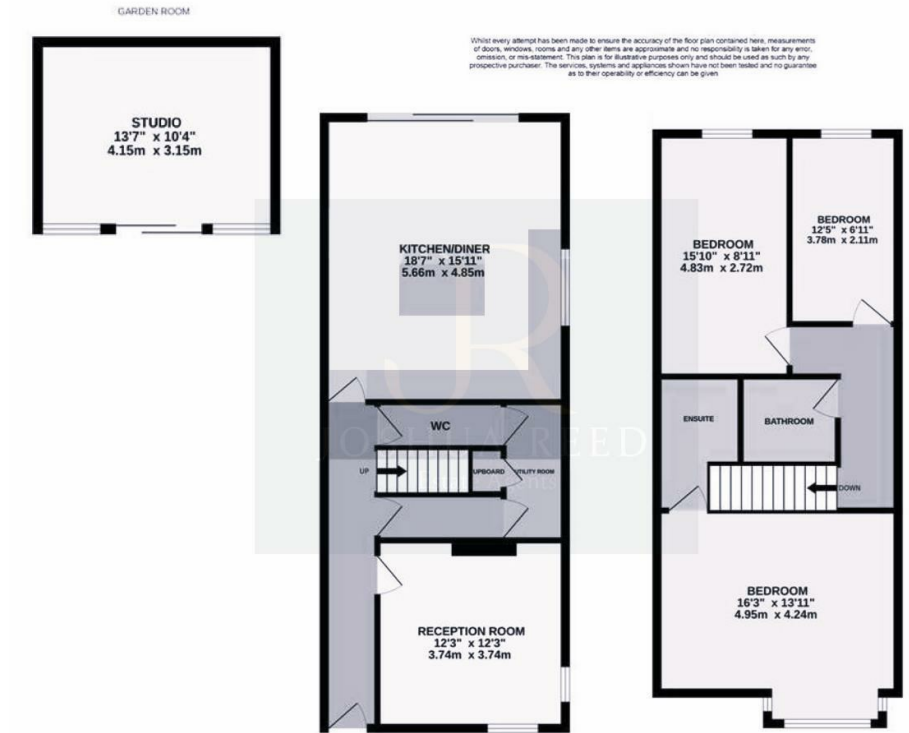

SUMMARY

A recently renovated and unique three bedroom detached property positioned on the ever sought and desirable southside location of Ware, catchment for excellent schooling and walking distance to Ware Town Centre and Train Station.

This property features an impressive family kitchen with bi folding doors leading to and overlooking the garden, a great room for entertaining. Additional on the ground floor is a utility room, dual aspect living room with wood burner fireplace and a useful downstairs w/c. Upstairs consists of the three bedrooms with luxury ensuite shower room to the master plus luxury family bathroom.

Externally there is a fantastic size rear garden which features a fully insulated garden room complete further with power and light, ideal for a home office/studio. Off street parking for several vehicles. Chain Free.

DIRECTIONS

