



Vicentia Court  
Bridges Court Road, SW11

CHESTERTONS





Chestertons is delighted to present this stunning two-bedroom, two-bathroom apartment, situated on the second floor of a highly sought-after riverside development.

Finished to an exceptional standard throughout, the property offers beautiful views over the River Thames. The spacious open-plan reception area is filled with natural light and opens onto the first of two private balconies, creating an ideal space for both relaxing and entertaining. The contemporary kitchen is fully fitted with high-quality integrated appliances, generous storage, and ample worktop space.

Both bedrooms are well-proportioned doubles, with the principal bedroom benefiting from a stylish en-suite shower room and its own private, river-facing balcony. A modern family bathroom completes the accommodation.

The apartment further benefits from two secure underground parking spaces—an increasingly rare advantage in this area.

Bridges Wharf is conveniently located just a 13-minute walk (0.6 miles) from Clapham Junction mainline station, offering excellent transport links into central London and beyond.

- Two bedrooms
- Two bathrooms
- River facing balconies
- Two parking spaces
- Direct river views
- 24H Concierge

Offers in excess of  
£650,000

Energy Efficiency Rating		Current	Potential
90-100	A		
81-89	B	83	83
69-80	C		
55-68	D		
39-54	E		
21-38	F		
1-20	G		

Not energy efficient - higher running costs

EU Directive 2002/91/EC  
England, Scotland & Wales

**Tenure:** Leasehold 129 years 11 months  
**Service Charge:** £5,970 Per Annum  
**Ground Rent:** £300 Per Annum  
**Local Authority:** Wandsworth Council  
**Council Tax Band:** F

*Chestertons Battersea Park & Nine Elms Sales*

62-64 Battersea Bridge Road  
 London  
 SW11 3AG  
 batterseapark@chestertons.co.uk  
 0203 040 8700  
 chestertons.co.uk

Vicentia Court,  
Bridges Court Road, SW11



○ - Ceiling Height

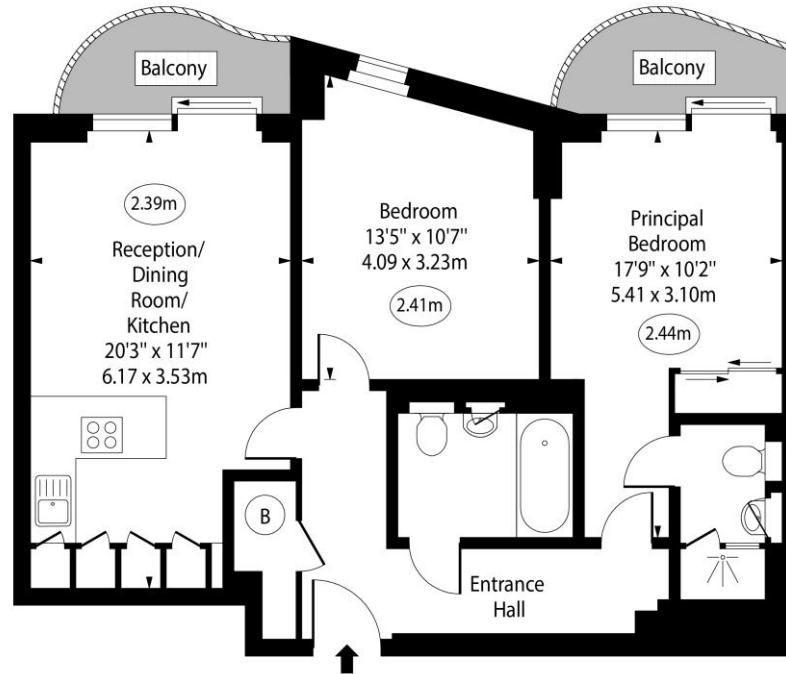

Second Floor

Approx Gross Internal Area 720 Sq Ft - 66.89 Sq M

For Illustration Purposes Only - Not To Scale  
www.goldlens.co.uk  
Ref. No. 025884M

Chesterton UK Services Limited trading as Chestertons for themselves and for the vendor of this property whose agents they are, give notice that (i) these particulars do not constitute any part of an offer or contract, (ii) all statements contained within these particulars are made without responsibility on the part of Chestertons or the vendor, (iii) whilst made in good faith, none of the statements contained within these particulars are to be relied upon as a statement or representation of fact, (iv) any intending purchasers must satisfy themselves by inspection or otherwise as to the correctness of each of the statements contained within these particulars, (v) the vendor does not make or give either Chestertons or any person in their employment any authority to make or give representation or warranty whatsoever in relation to this property. Wide angle lenses may be used. ©Copyright Chestertons | Chesterton UK Services Limited | Registered Office 5th Floor, The Lantern, 75 Hampstead Road, London, NW1 2PL Registered Company Number 05334580.



This paper is  
100% recyclable