

Abbots Manor, SW1V

£1,038 Per week

A beautifully recently refurbished three bedroom flat in a purpose built block with wooden flooring throughout and two balconies. Perfect for three sharers or a family.

Abbots Manor is situated a short distance from the local amenities on Warwick Way and Wilton Road such as Sainsburys and the numerous cafes and restaurants, and is also only a 10 minute walk to Sloane Square and Kings Road. Victoria and Sloane Square are the nearest stations.

Features

- Three Bedroom
- Two Bathroom
- Granite Worktop
- Wooden Floors
- Two Balconies
- Third Floor

Abbots Manor, London, SW1V

KIRKSTALL HOUSE

Approximate Gross Internal Area

805 sq. ft. (74.8 sq. m.)

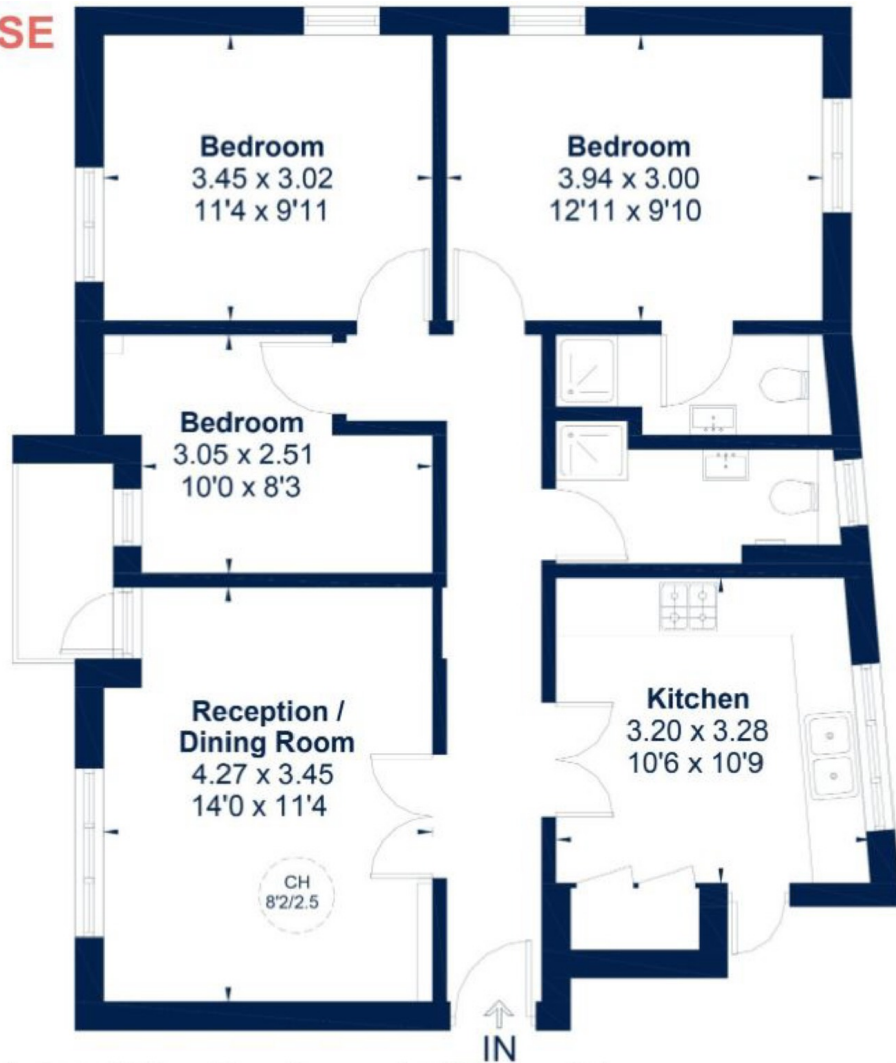

Third Floor

Dexters

Pimlico
42 Denbigh Street
London
SW1V 2ER

Lettings
020 7976 5200

Energy Rating: . We aim to make our particulars both accurate and reliable. However they are not guaranteed; nor do they form part of an offer or contract. If you require clarification on any points then please contact us, especially if you're traveling some distance to view. Please note that appliances and heating systems have not been tested and therefore no warranties can be given as to their good working order.



dexters.co.uk