



## 27 Goldfinch Road

Melksham, SN12 7FL

### Guide Price £425,000

Welcome to Goldfinch Road, Melksham, a four bedroom detached family house with a double garage, parking and an enclosed rear garden built by Charles Church in 2011.

The ground floor accommodation comprises entrance hall with understairs storage cupboard, dining room, lounge with fireplace and patio doors leading onto the garden, cloakroom, kitchen breakfast room with patio doors onto the garden and utility room with access door onto the rear garden. There is an awning over the rear patio doors.

The first floor accommodation comprises landing with airing cupboard, main bedroom with en-suite shower room, three further double bedrooms and bathroom.

The property further benefits from gas central heating, double glazing, a double garage with electric and parking for approximately 4 cars and an enclosed rear garden.

The yearly estate charge is currently £120 payable to Greensquare as advised by the property owner.

- Four Bedroom Detached Home
- Two Reception Rooms
- Kitchen/Breakfast Room
- Utility Room
- Family Bathroom & Ensuite
- Enclosed Rear Garden
- Double Garage
- Cul-de-sac location

### Viewing

Please contact our Blueleaf Property Office on 01225 839050 if you wish to arrange a viewing appointment for this property or require further information.



## Floor Plan

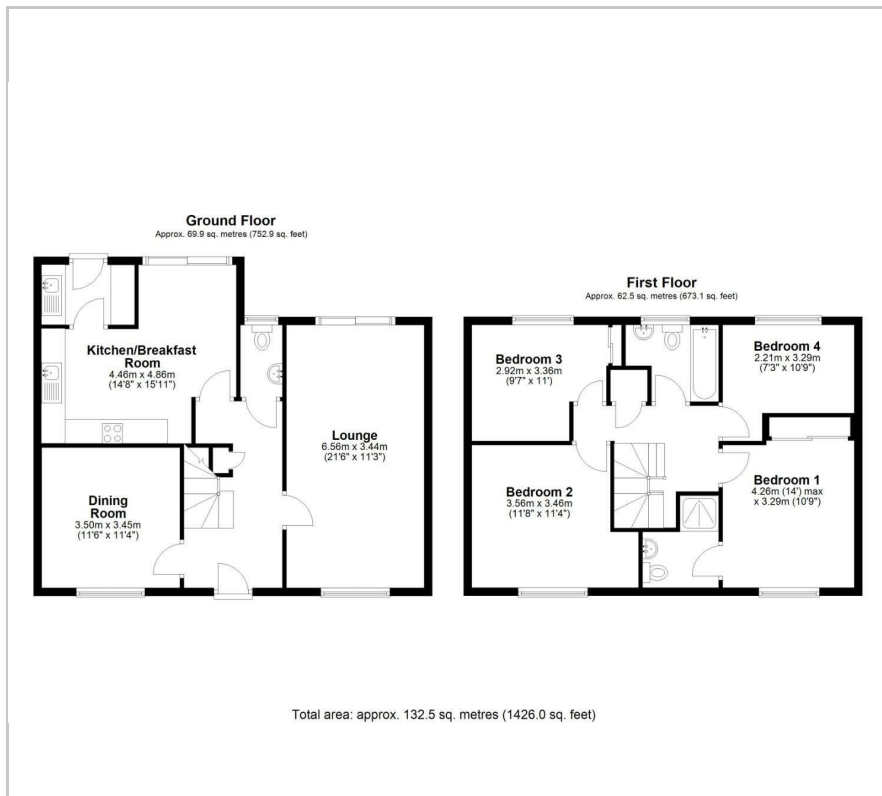

## Area Map



## Energy Efficiency Graph

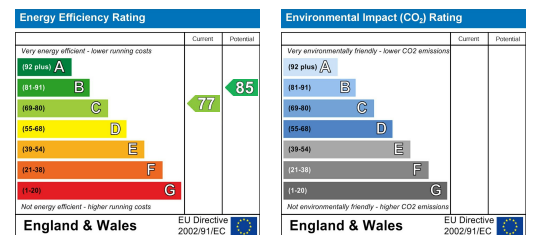

These particulars, whilst believed to be accurate are set out as a general outline only for guidance and do not constitute any part of an offer or contract. Intending purchasers should not rely on them as statements of representation of fact, but must satisfy themselves by inspection or otherwise as to their accuracy. No person in this firm's employment has the authority to make or give any representation or warranty in respect of the property.

Office 4 Stockley Farm, Stockley, Wiltshire, SN11 0NT

Tel: 01225 839050 Email: [hello@blueleafproperty.co.uk](mailto:hello@blueleafproperty.co.uk) <https://www.blueleafproperty.co.uk>