



Grafton Road

Kentish Town London NW5 4AX

£1,299,500

A fabulous four bedroom period house, forming part of a picturesque terrace, presented in excellent order and situated within easy reach of Hampstead Heath. Offering 1486 square feet (138 square metres) of well-planned accommodation, the property has been the subject of extensive refurbishment works and is presented to a high standard throughout.

On the ground floor a good-size through reception is complemented by a well-equipped eat-in kitchen, separate utility room and guest wc.

The first floor comprises master bedroom, further double bedroom and a spacious contemporary family bathroom. The top floor offers two good double bedrooms and shower room/wc.

To the rear is a charming low-maintenance garden.

Grafton Rd is centrally and conveniently situated in the heart of Kentish Town, within easy reach of Kentish Town Underground (Northern Line) and Thameslink, Kentish Town West Overground and Hampstead Heath. A range of excellent local schools are close by, including the Collège Français Bilingue de Londres in Holmes Rd

- Fabulous period terraced house
- Four double bedrooms
- Through reception
- Extended eat-in kitchen
- Two bathrooms
- Ground floor guest wc
- Excellent decorative order
- Convenient location
- Low maintenance rear garden
- Chain free sale

Viewing

Please contact our Kentish Town Sales Office on 0207 482 4488 if you wish to arrange a viewing appointment for this property or require further information.



4



2



2



D

Floor Plan

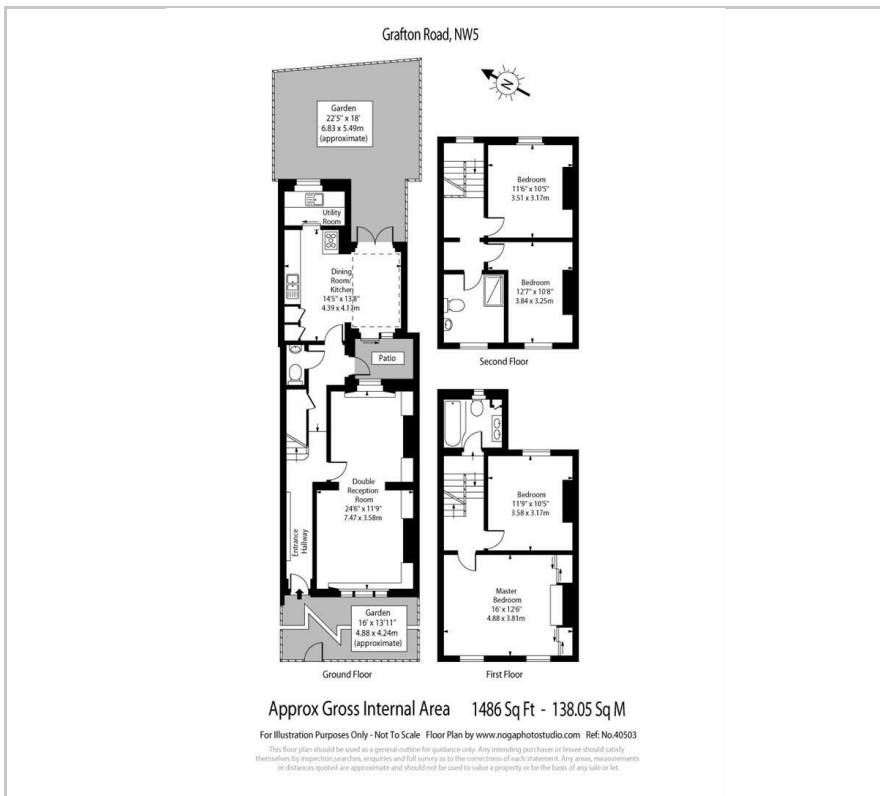

Area Map

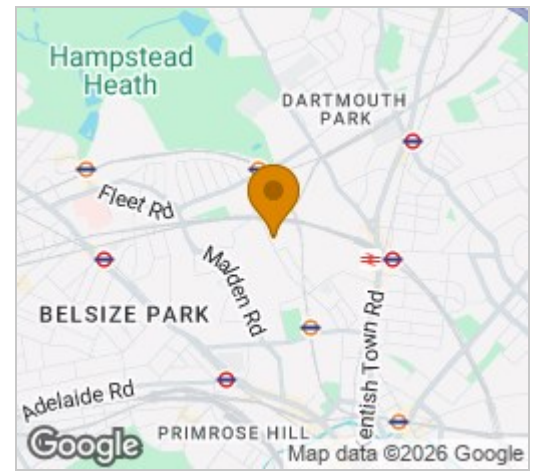

Energy Efficiency Graph

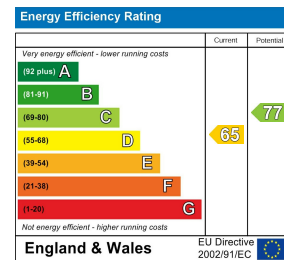

These particulars, whilst believed to be accurate are set out as a general outline only for guidance and do not constitute any part of an offer or contract. Intending purchasers should not rely on them as statements of representation of fact, but must satisfy themselves by inspection or otherwise as to their accuracy. No person in this firm's employment has the authority to make or give any representation or warranty in respect of the property.