



**For Sale**

**57 Desdemona Avenue, Gates**

**Offers Over £160,000**

**\*\*\* ONE DOUBLE BEDROOM MAISONETTE BEING OFFERED FOR SALE WITH NO ONWARD CHAIN \*\*\***

 **1**

 **1**

 **1**

 **925 sq ft**

 **463 sq ft**

**Nathaniel Cleaver**

07793 363210

nathaniel@thepropertyexperts.co.uk

... WELL PRESENTED DOUBLE BEDROOM MEWS HOUSE OFFERED FOR SALE WITH NO ONWARD CHAIN ...

The property offers excellent local amenities including local shops and schools, while also offering easy access into Warwick town centre. For commuters there are frequent trains from Leamington Spa Train Station and access to the Warwick Bypass and M40 motorway network.

The property has a very good record as a buy to let property or would also be ideal for first time buyers, downsizers and investors either looking to rent it out long term or Air B and B it.

In brief the property comprises of; open plan lounge / kitchen / dining area, double bedroom and white bathroom suite, there is also storage over the top of the stairs.

Further benefits include double glazing throughout and there is no onward chain.

CALL NOW TO VIEW!

Tenure - Leasehold..



**The Property Experts UK**

01926436105



Total Living Area 49.86 square metres / 537 square feet

Ground Floor

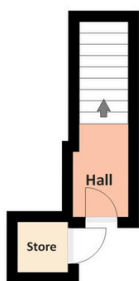

First Floor

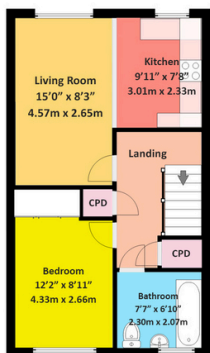

- First Floor Maisonette
- One Double Bedroom
- Popular Location
- Open Plan Lounge / Kitchen / Dining Area
- Bathroom
- Double Glazed
- Allocated Parking
- Close To All Local Amenities, Shops, Schools, Parks etc.
- No Onward Chain
- EPC Rating - C

THIS FLOORPLAN IS PROVIDED WITHOUT WARRANTY OF ANY KIND. THE PUBLISHER DISCLAIMS ANY WARRANTY INCLUDING, WITHOUT LIMITATION, SATISFACTORY QUALITY OR ACCURACY OF DIMENSIONS

