



ABBEEY ROAD

ST JOHN'S WOOD, NW8

£3,900 PER MONTH

A beautiful and well presented 2 bedroom, 2 bathroom apartment found in a superb location on London's historic Abbey Road, moments from local amenities. Comprising of a large open-plan kitchen/reception room, 2 double bedrooms and 2 bathrooms.

Located moments from a host of local shops and amenities found on Abbey Road itself, the property is close to the heart of St John's Wood, with the West End also within easy reach.

PMP | INTERNATIONAL

Approximate Gross Internal Area 799 sq ft – 74 sq m

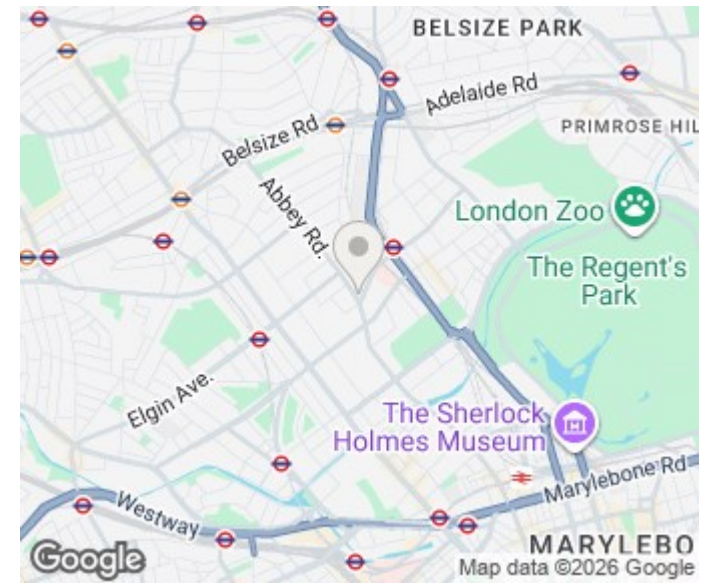
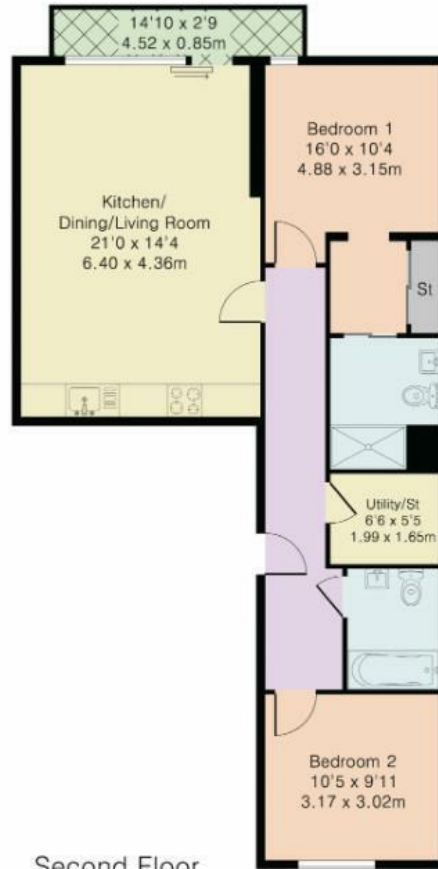

Energy Efficiency Rating		
	Current	Potential
Very energy efficient - lower running costs		
(92 plus) A		
(81-91) B		
(69-80) C		
(55-68) D		
(39-54) E		
(21-38) F		
(1-20) G		
Not energy efficient - higher running costs		
England & Wales	83	83
	EU Directive 2002/91/EC	

Agents Note: Whilst every care has been taken to prepare these particulars, they are for guidance purposes only. All measurements are approximate and are for general guidance purposes only and whilst every care has been taken to ensure their accuracy, they should not be relied upon and potential buyers/tenants are advised to recheck the measurements

London
PMP International
94 Belsize Lane
Belsize Park
London
NW3 5BE

020 7701 2878
info@pmpi.co.uk
www.pmpi.co.uk

PMP | INTERNATIONAL