



Watchfield Court, Sutton Court Road, London, W4 4NB

HEATING & HOT WATER INCLUDED. A lovely one-bedroom flat ideally located in this sought-after mansion block close to all amenities of Chiswick High Road and with the added benefit of a private sun filled balcony and off-street parking. Comprising a double bedroom with fitted wardrobes, tiled bathroom, reception room with French windows onto an impressive West facing 23' balcony, fully integrated kitchen with full size fridge freezer, automatic lift, communal landscaped gardens and a porter. Ideally located just South of Chiswick High Road with its extensive transport links and shopping facilities. Hounslow Council Tax Band D. EPC-D. Furnished as pictured. Available now.

- Excellent location
- Heating & hot water included
- Private sunny 23' balcony
- Well presented throughout
- Automatic lift and porter
- Sought after mansion block
- Furnished as pictured
- Communal gardens and off street parking
- Available Now

£2,000 Per Calendar Month

Watchfield Court, W4

Approximate gross internal area

39.36 sq m / 424 sq ft

Key :
CH - Ceiling Height

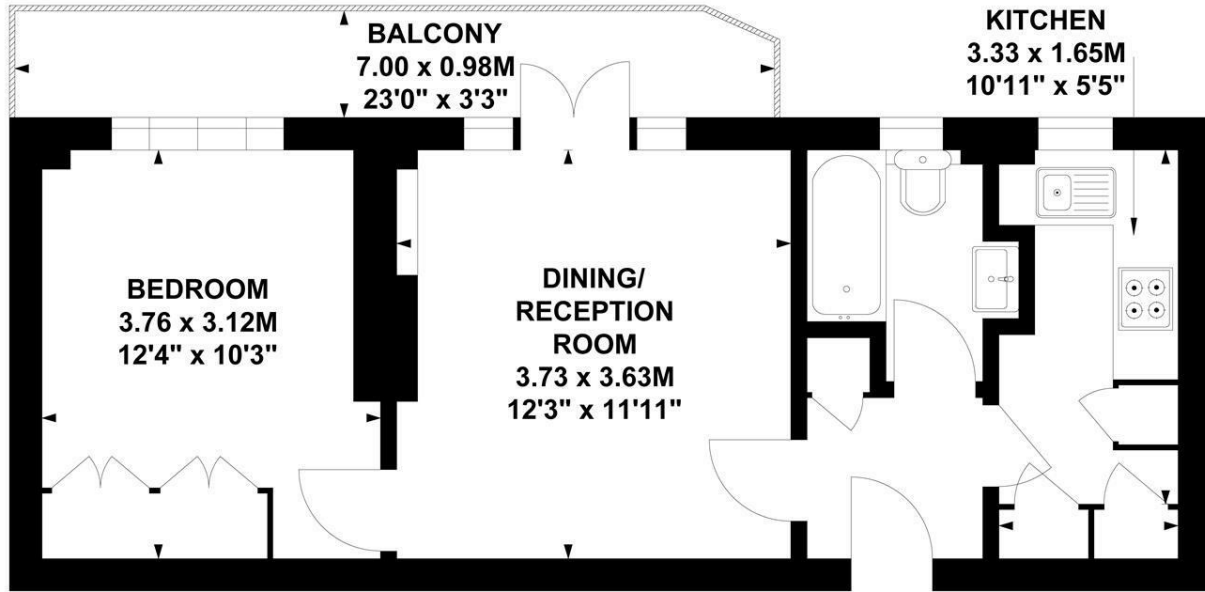

Third Floor

Not to scale, for guidance only and must not be relied upon as a statement of fact.
All measurements and areas are approximate only

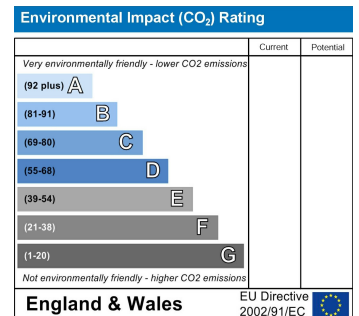
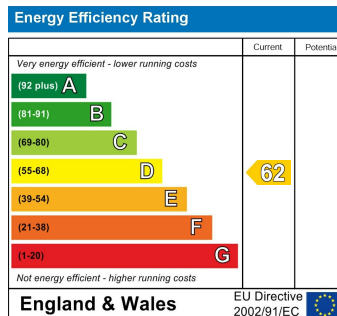

5-7 Turnham Green Terrace, Chiswick, London, W4 1RG

Tel 020 8747 8800

E-mail lettings@whitmanandco.com

Website www.whitmanandco.com