

for sale

£270,000



Lordswood Close Wootton Northampton NN4 6BP

Offered to the market with no onward chain, this beautifully renovated three-bedroom end-of-terrace property is presented in immaculate condition throughout. The home has been fully refurbished and benefits from a new kitchen, modern bathroom, and new flooring throughout.

Lordswood Close Wootton Northampton NN4 6BP

Entrance Hall

Double glazed door to the front elevation. Stairs rising to first floor landing. Radiator.

Lounge

Double glazed bay window to the front elevation. Radiator. Door to kitchen.

Kitchen

Brand new kitchen with a range of wall and base level units. One and a half bowl stainless steel sink and drainer set into work surface. Integrated oven, and electric hob with cooker hood over. Plumbing for washing machine. Space for fridge freezer. Storage cupboard. Fuse box. Spots lights. Radiator. New flooring. Double glazed window and door to the rear elevation.

First Floor Landing

Stairs rising from entrance hall. Airing cupboard. Loft access. Doors leading to three bedrooms and family bathroom.

Bedroom One

Double glazed window to the rear elevation. Radiator.

Bedroom Two

Double glazed window to the front elevation. Radiator.

Bedroom Three

Double glazed window to the front elevation. Radiator.

Family Bathroom

Brand new, three piece white suite comprising bath with shower screen and shower over, low level flush w.c and pedestal wash hand basin with tiling to splash back areas and floor. Extractor fan. Shaver point. Heated towel rail. Opaque double glazed window to the side elevation.



Outside

Front Garden

Path leading to the front of the property. Driveway providing off road parking. Gated side access leading to the rear garden.

Rear Garden

Hard standing rear corner. Mainly laid to lawn. Patio area ideal for entertaining and relaxation. Retaining timber fencing. Gated side access leading to the front of the property.



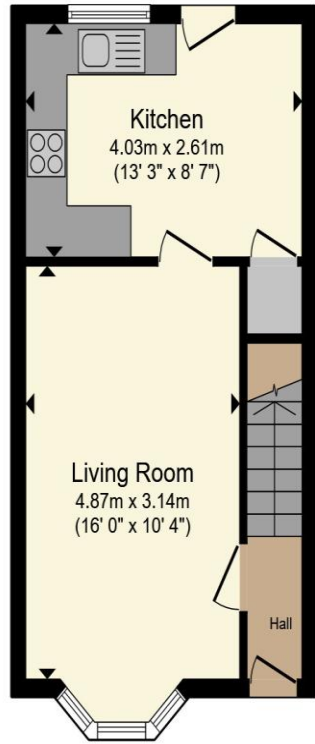

Ground Floor

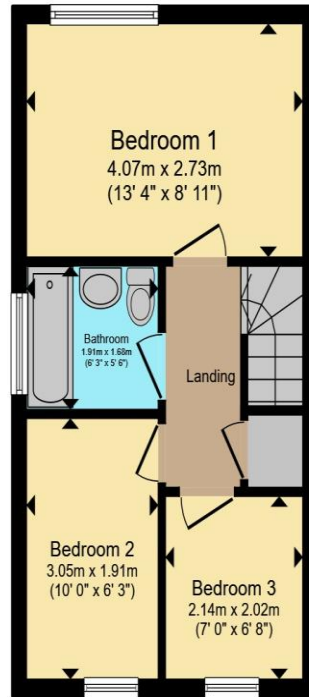

First Floor

Total floor area 61.9 m² (667 sq.ft.) approx

This floor plan is for illustrative purposes only. It is not drawn to scale. Any measurements, floor areas (including any total floor area), openings and orientation are approximate. No details are guaranteed, they cannot be relied upon for any purpose and they do not form part of any agreement. No liability is taken for any error, omission or misstatement. A party must rely upon its own inspection(s). Powered by www.propertybox.io



To view this property please contact Connells on

T 01604 706644
E woottonfields@connells.co.uk

11 Tudor Court Wootton Hope Drive Wootton
 NORTHAMPTON NN4 6FF

Property Ref: WFL408798 - 0002

Tenure:Freehold EPC Rating: D

Council Tax Band: C

view this property online
connells.co.uk/Property/WFL408798



1. MONEY LAUNDERING REGULATIONS Intending purchasers will be asked to produce identification documentation at a later stage and we would ask for your co-operation in order that there will be no delay in agreeing the sale. 2. These particulars do not constitute part or all of an offer or contract. 3. The measurements indicated are supplied for guidance only and as such must be considered incorrect. Potential buyers are advised to recheck measurements before committing to any expense. 4. We have not tested any apparatus, equipment, fixtures, fittings or services and it is in the buyers interest to check the working condition of any appliances.

Connells Residential is registered in England and Wales under company number 1489613, Registered Office is Cumbria House, 16-20 Hockliffe Street, Leighton Buzzard, Bedfordshire, LU7 1GN. VAT Registration Number is 500 2481 05.

see all our properties at www.connells.co.uk | www.rightmove.co.uk | www.zoopla.co.uk