



## Portinscale

Offers in the region of **£330,000**

Ivy Cottage, Portinscale, Keswick, CA12 5RF

A charming two bedroom period terrace cottage with a rear garden centrally located in Portinscale village and equally suitable for use as a primary home, recreational second home or for lucrative holiday rentals.

Portinscale is conveniently located off the A66 less than two miles west of Keswick in a stunning rural Lakeside setting by Derwentwater and provides a range of local amenities including two marinas, village hall, public house and café/restaurant.

### Quick Overview

Charming two bedroom period terrace cottage

Central location in Portinscale village

Under two miles and within a 20 minute walk from Keswick town centre

Living room and dining kitchen

Rear garden

Equally suitable as a primary home, recreational second home or for lucrative holiday rentals

Property Reference: KW0520



2



1



1



E



Ultrafast  
Broadband  
Available



1



Living Room



Living Room



Kitchen Dining



Dining Area

## Accommodation

### Ground Floor:

#### Living Room

With electric heater.

#### Dining Kitchen

With fitted base and wall units, sink, electric heater.

### First Floor:

#### Landing

With electric heater, storage cupboard housing hot water tank.

#### Bedroom One

#### Bedroom Two

#### Bathroom

With WC, wash hand basin, bath with shower over.

### Outside:

Rear garden with raised bed of shrubs.



Living Room



Kitchen Dining



Bedroom One



Bedroom One



Bathroom



Bathroom

### Directions

From Keswick town centre proceed west on the A66 towards Cockermouth and turn left where sign posted to Portinscale. Proceed ahead into the village centre and bear right towards the marina. The property is situated in the row of cottages on the right before the cafe.

### What3words

///evolving.generated.hero

### Price

Offers in the region of £330,000 are invited for consideration.

### Anti-Money Laundering Regulations (AML)

Please note that when an offer is accepted on a property, we must follow government legislation and carry out identification checks on all buyers under the Anti-Money Laundering Regulations (AML). We use a specialist third-party company to carry out these checks at a charge of £42.67 (incl. VAT) per individual or £36.19 (incl. VAT) per individual, if more than one person is involved in the purchase (provided all individuals pay in one transaction). The charge is non-refundable, and you will be unable to proceed with the purchase of the property until these checks have been completed. In the event the property is being purchased in the name of a company, the charge will be £120 (incl. VAT).



Bedroom One



Bedroom Two



Garden Area



Rear Garden

Request a Viewing Online or Call 01768 741741

# Meet the Team

## Nick Elgey

Sales Manager & Property Valuer

Tel: 017687 41741  
Mobile: 07368 416931  
nre@hackney-leigh.co.uk



## Simon Bennett

Sales Team

Tel: 017687 41741  
keswicksales@hackney-leigh.co.uk



## Dawn Branson

Sales Team

Tel: 017687 41741  
keswicksales@hackney-leigh.co.uk



## Sue Jackson

Viewing Assistant

Tel: 017687 41741  
keswicksales@hackney-leigh.co.uk



## Angela Bell

Viewing Assistant

Tel: 017687 41741  
keswicksales@hackney-leigh.co.uk



## Chris Houghton

Viewing Assistant

Tel: 017687 41741  
keswicksales@hackney-leigh.co.uk



Viewings available 7 days a week including evenings with our dedicated viewing team  
Call **01768 741741** or request online.



Need help with **conveyancing**? Call us on: **01539 792032**



Can we save you money on your **mortgage**? Call us on: **01539 792033**

Hackney & Leigh Ltd 11 Bank Street, Keswick, Cumbria, CA12 5JY | Email: [keswicksales@hackney-leigh.co.uk](mailto:keswicksales@hackney-leigh.co.uk)

## Ground Floor

Approx. 26.7 sq. metres (286.9 sq. feet)

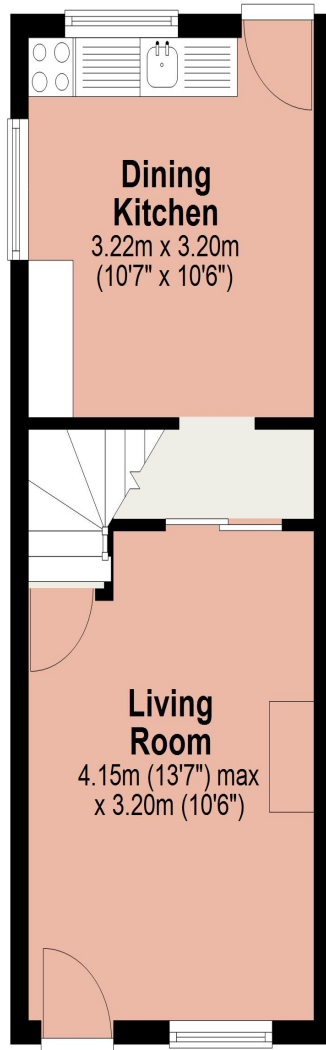

## First Floor

Approx. 25.6 sq. metres (275.4 sq. feet)

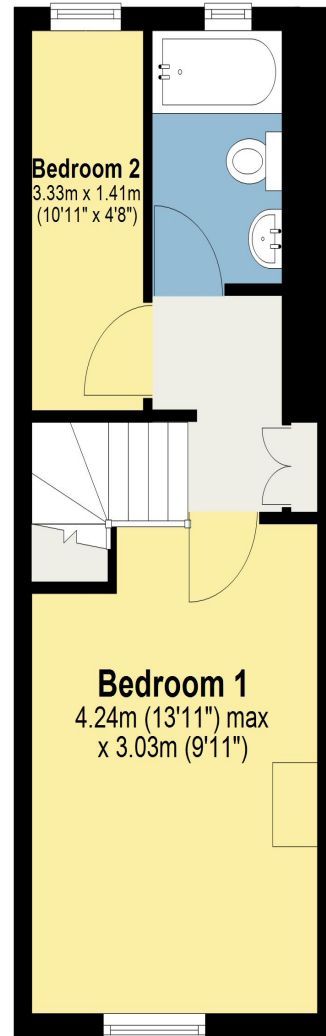

Total area: approx. 52.2 sq. metres (562.3 sq. feet)

This plan is for layout guidance only and is not drawn to scale unless stated. Windows and door openings are approximate. Whilst every care is taken in preparation of this plan, please check all dimensions, shapes and compass bearings before making any decision reliant upon them. REF:  
Plan produced using PlanUp.

## Ivy Cottage, Portinscale

All permits to view and particulars are issued on the understanding that negotiations are conducted through the agency of Messrs. Hackney & Leigh Ltd. Properties for sale by private treaty are offered subject to contract. No responsibility can be accepted for any loss or expense incurred in viewing or in the event of a property being sold, let, or withdrawn. Please contact us to confirm availability prior to travel. These particulars have been prepared for the guidance of intending buyers. No guarantee of their accuracy is given, nor do they form part of a contract. \*Broadband speeds estimated and checked by <https://checker.ofcom.org.uk/en-gb/broadband-coverage> on 09/03/2026.

Request a Viewing Online or Call 01768 741741