



3 Blakeway Mews, Bicton Heath, Shrewsbury, Shropshire, SY3 5AR

£185,000

A greatly improved and refurbished two-bedroom end terrace property set in a cul-de-sac position in this popular location, for sale with No Upward Chain. There are excellent local amenities close by, including shops, a cafe and the highly rated Oxon Primary School. There are good road links to the A5 and M54, and the town centre and Royal Shrewsbury Hospital are within easy access. The accommodation includes an Entrance Hall, a Kitchen with integrated oven and hob, a Living Room, 2 Bedrooms and a Bathroom with a shower. There is an enclosed Garden, an Allocated Parking Space, Gas Central Heating, and Double Glazing. This property would be an ideal purchase for first-time buyers or investors.

Early Viewing Highly Is Recommended.



3 Blakeway Mews, Bicton Heath, Shrewsbury, Shropshire, SY3 5AR

The mention of any appliances and/or services within these sales particulars does not imply that they are in full and efficient working order.

Entrance Hall

Kitchen 8' 7" x 6' 7" (2.61m x 2m)

Living Room 14' 7" x 13' 0" (4.44m x 3.95m)

Bedroom 1 10' 0" x 8' 3" (3.04m x 2.51m)

Bedroom 2 13' 0" x 8' 7" (3.97m x 2.61m)

Bathroom 7' 2" x 5' 5" (2.18m x 1.66m)

Allocated Parking Space

Council Tax Band B

Tenure: Our client advises us that the property is Freehold. Should you proceed with the purchase of the property, these details must be verified by your solicitor.

Viewing: To arrange a viewing call in at our office or telephone **01743 248351**

Ground Floor

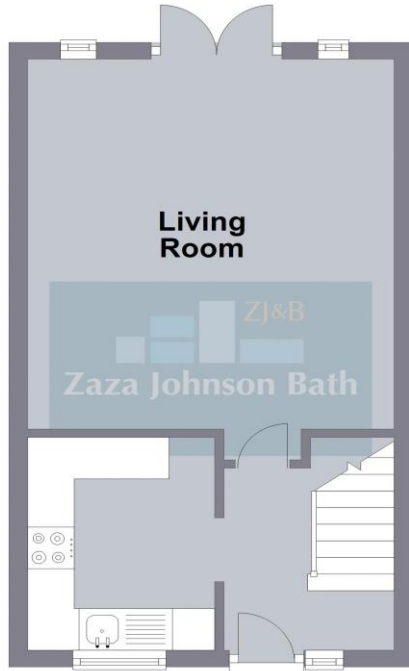

First Floor

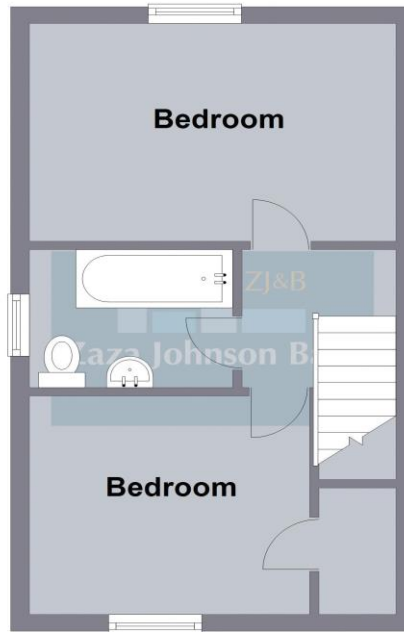

FLOOR PLANS FOR GUIDANCE ONLY

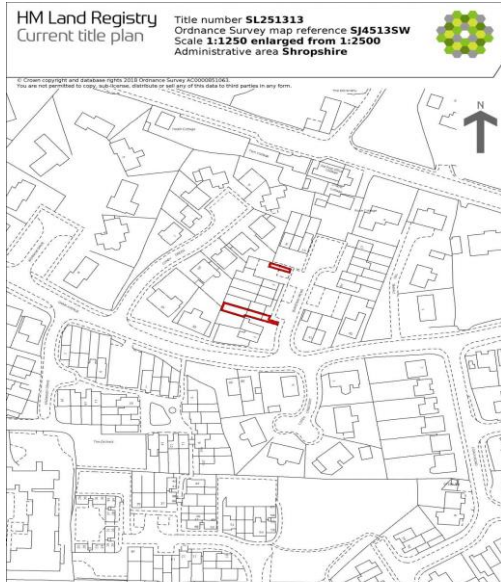

This is a copy of the title plan on 22 APR 2026 at 12:21:39. This copy does not take account of any application made after that time even if still pending in HM Land Registry when this copy was issued.

This copy is not an "Official Copy" of the title plan. An official copy of the title plan is admissible in evidence in a court to the same extent as the original. A person is entitled to be indemnified by the registrar if he or she suffers loss by reason of a mistake in an official copy. If you want to obtain an official copy, the HM Land Registry web site explains how to do this.

HM Land Registry endeavours to maintain high quality and scale accuracy of title plan images. The quality and accuracy of any print will depend on your printer, your computer and its print settings. This title plan shows the general position, not the exact line, of the boundaries. It may be subject to distortions in scale. Measurements scaled from this plan may not match measurements between the same points on the ground.

This title is dealt with by HM Land Registry, Telford Office.

Energy performance certificate (EPC)

3, Blakeway Mews Bicton Heath SHREWSBURY SY3 5AR	Energy rating	Valid until:	13 February 2028
	C	Certificate number:	9478-2060-7222-5868-3974

Property type end-terrace house

Total floor area 55 square metres

Rules on letting this property

Properties can be let if they have an energy rating from A to E.

You can read [guidance for landlords on the regulations and exemptions](https://www.gov.uk/guidance/domestic-private-rented-property-minimum-energy-efficiency-standards-landlord-guidance) (<https://www.gov.uk/guidance/domestic-private-rented-property-minimum-energy-efficiency-standards-landlord-guidance>).

Energy rating and score

This property's energy rating is C. It has the potential to be B.

[See how to improve this property's energy efficiency.](#)



FREE MORTGAGE ADVICE

Whether you are a first time buyer, moving home, buying as an investor or looking to save on your mortgage payments, you will benefit from some **free** no obligation mortgage advice. To arrange an appointment with Stephen Bath of Bee Mortgages, who is based at our office, call us on **01743 248351**

Whole of Market, clear and relevant tailored to your individual needs and circumstances.

Your home may be repossessed if you do not keep up repayments on your mortgage