



## Oxford Gardens, W10

£340 Per week

A bright and spacious studio apartment situated on the first floor of this impressive period conversion in Notting Hill. The property has high ceilings throughout and a separate sleeping area.

Ideally located in the heart of Notting Hill with access to the shops and restaurants on Golborne Road including Pizza East and Bluebells.

### Features

- Studio Apartment
- Self Contained
- First Floor Flat
- High Ceilings
- Bright And Spacious

# Oxford Gardens, London, W10

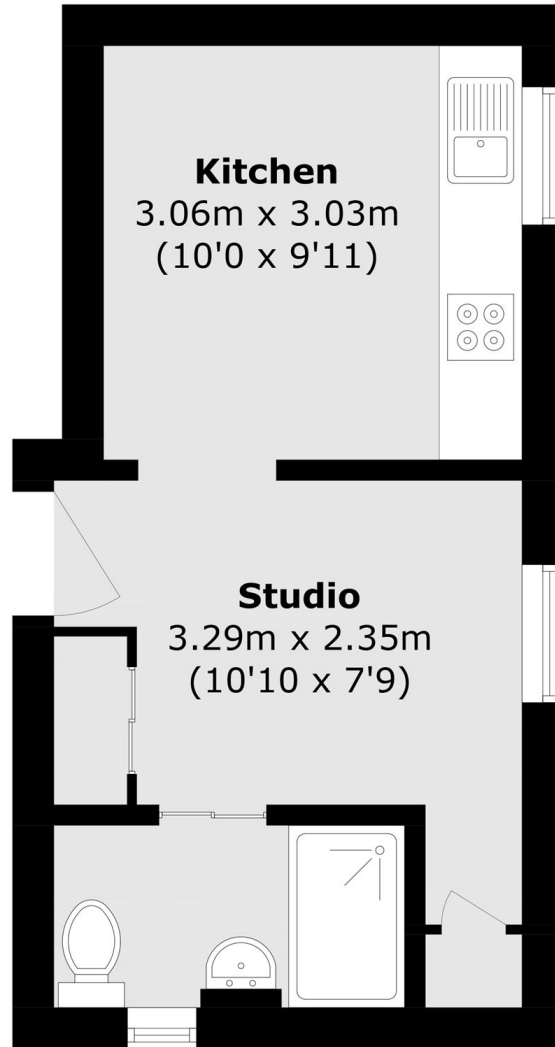

Total area (approx.): 22.5 sq. m (242.2 sq. ft)