





📍 Papon Milbourne, Malmesbury, SN16 9JB

🏠 Price Guide £625,000

A well presented individual 4 bedroom detached bungalow situated in the very popular hamlet of Milbourne.

- Individual Detached Bungalow
- Four Bedrooms
- Driveway and Garage
- Popular Location

🏠 Freehold

🏠 EPC Rating D





A well proportioned individual 4 bedroom detached bungalow situated in the extremely popular hamlet of Milbourne with a large garage, driveway and walled gardens. The property has been well maintained and updated by the current owners.

Upon entering the property you are greeted by a large entrance hallway, the central hallway runs through the middle of the house providing access to all rooms. There is a large open plan sitting/dining room to the front with large windows allowing an abundance of light. There is a modern refitted kitchen with a breakfast peninsula and a range of integrated appliances. A door leads from the kitchen to a spacious utility with space for stacked washing machine and tumble dryer, there are doors to the garage and garden.

To the rear half of the bungalow you will find a master bedroom with refitted ensuite, 2 further bedrooms and a single bedroom/study. All bedrooms have built in wardrobes. There is also a refitted family bathroom with four piece suite.

Externally there are gardens to 3 sides making it a very versatile and useable space. There are vegetable patches to one side, a greenhouse and useful brick built workshop/store. There is a large garage with up and over door to the front as well as a gravelled driveway providing off road parking for 3 cars. The property has been re-roofed recently.



### Floor Plan

Approx. 146.3 sq. metres (1574.4 sq. feet)

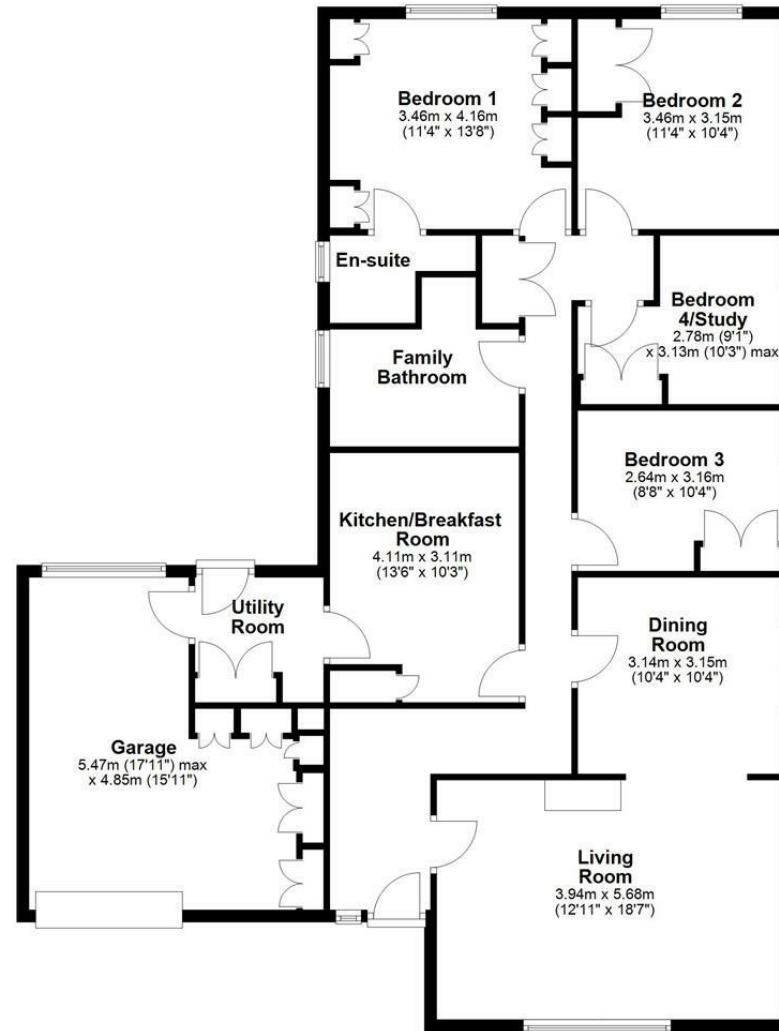

Total area: approx. 146.3 sq. metres (1574.4 sq. feet)

Disclaimer: These particulars, whilst believed to be accurate are set out as a general outline only for guidance and do not constitute any part of an offer or contract. Intending purchasers should not rely on them as statements of representation of fact, but must satisfy themselves by inspection or otherwise as to their accuracy. No person in this firm's employment has the authority to make or give any representation or warranty in respect of the property. All measurements and distances are approximate only. Your home is at risk if you do not keep up repayments on a mortgage or other loan secured on it.