



Bath Terrace SE1

£350,000
LEASEHOLD

A charming Victorian Mansion flat, with attractive views over the neighbouring park, a separate kitchen & living room, high ceilings & sash windows. Bath Terrace is under 0.5 miles from Borough underground & Borough High Street & 0.25 miles from Elephant & Castle, next to Newington Gardens. Mercato Metropolitano is just around the corner, with many other amenities nearby.

Call the sales department to reserve a viewing.



- Two Bedroom Apartment • Sash Windows • Ground Rent - £10 Per Annum • Fourth Floor • Great Location





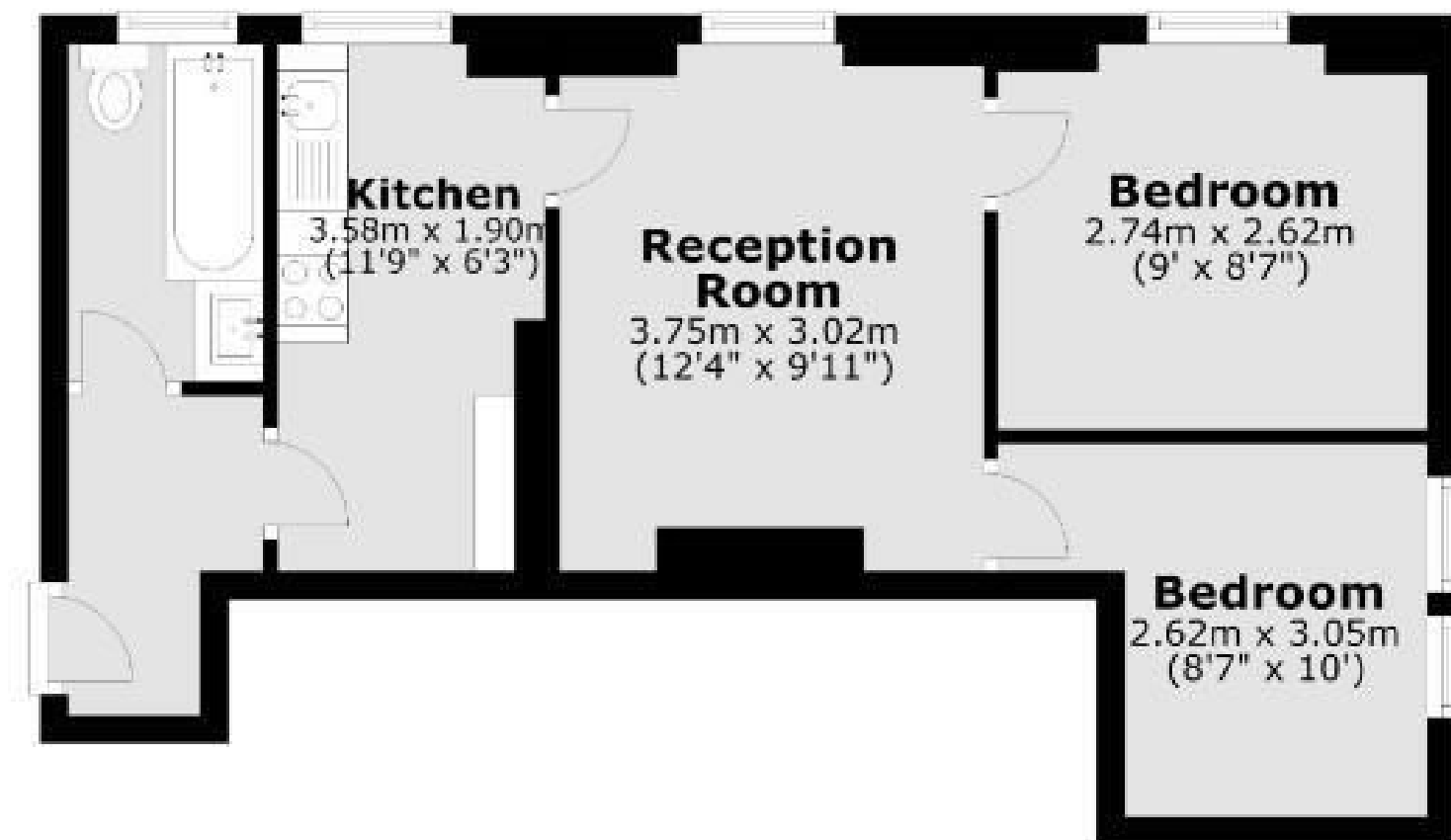

Total area: approx. 40.8 sq. metres (439.7 sq. feet)



Energy Efficiency Rating		
	Current	Potential
Very energy efficient - lower running costs		
(92 plus) A		
(81-91) B		
(69-80) C		
(55-68) D		
(39-54) E		
(21-38) F		
(1-20) G		
Not energy efficient - higher running costs		
	59	78
England & Wales		EU Directive 2002/91/EC

Agents Note: Whilst every care has been taken to prepare these particulars, they are for guidance purposes only. All measurements are approximate and are for general guidance purposes only and whilst every care has been taken to ensure their accuracy, they should not be relied upon and potential buyers/tenants are advised to recheck the measurements

Borough Lettings
230 Borough High Street
London
SE1 1JX

020 7015 1360
enquiries@leonardleese.com
www.leonardleese.com

