



Danvers Way , Westbury

Offers in excess of £145,000



Key Features

- End of chain
- 2 allocated tandem parking spaces
- EPC rating D
- Freehold



Step into this low-maintenance home, perfect for first-time buyers, those looking to downsize, or investors. While the property would benefit from some modernisation to the kitchen and bathroom, it offers fantastic potential.

The home features a welcoming porch and a bright, open-plan living room and kitchen, creating a comfortable and practical living space.

Upstairs, you'll find a double bedroom and a bathroom, making everyday living simple and convenient. Electric heating throughout adds to the home's practicality.

Outside, there are fully enclosed front and side gardens, complete with a patio area—ideal for relaxing. Two tandem parking spaces close to the property conveniently located to the side of the property.

Situated close to parks, local schools, and Westbury train station, this home is well positioned for both convenience and lifestyle.

Approx Gross Internal Area
36 sq m / 388 sq ft

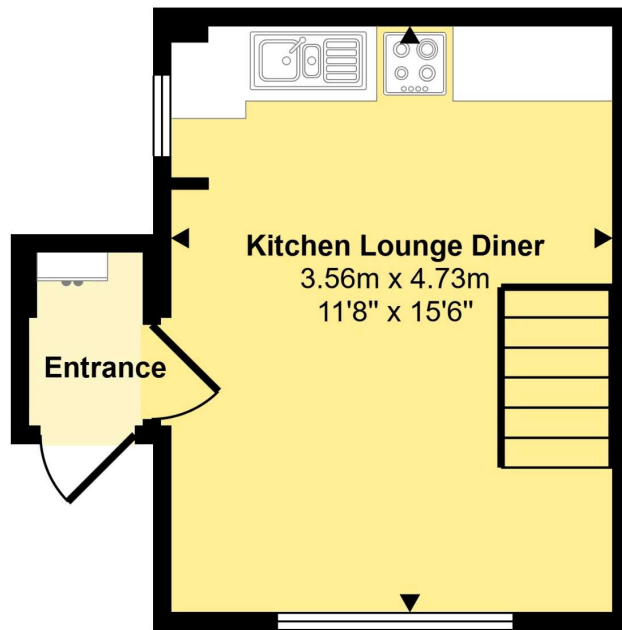

Ground Floor
Approx 18 sq m / 199 sq ft

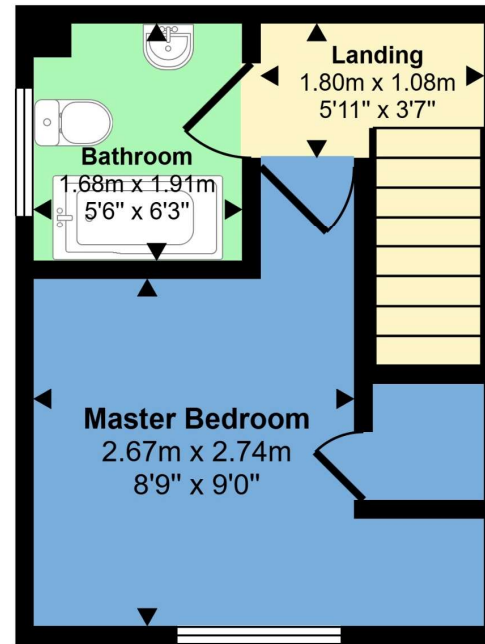

First Floor
Approx 17 sq m / 188 sq ft

This floorplan is only for illustrative purposes and is not to scale. Measurements of rooms, doors, windows, and any items are approximate and no responsibility is taken for any error, omission or mis-statement. Icons of items such as bathroom suites are representations only and may not look like the real items. Made with Made Snappy 360.

