

THE HOME AGENCY

'Passion for property.'



129 Wallace Court, The Dell, Southampton, Hampshire, SO15 2PX

£1,295 PCM

- Purpose Built Apartment.
- White Goods
- Large Lounge
- Geothermal Heating
- Two Double Bedrooms
- Ensuite To Master Bedroom
- Family Bathroom
- Two Off Road Parking Spaces
- Double Glazing
- Access To Communal Gym

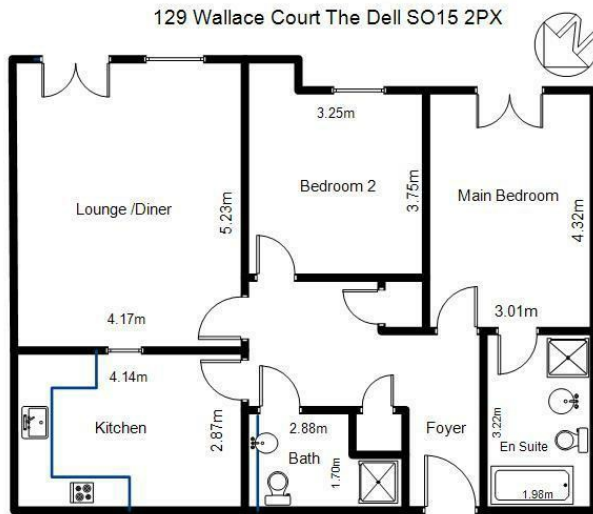

Top Floor Flat
81.36 Msq

ALL MEASUREMENTS ARE APPROXIMATE

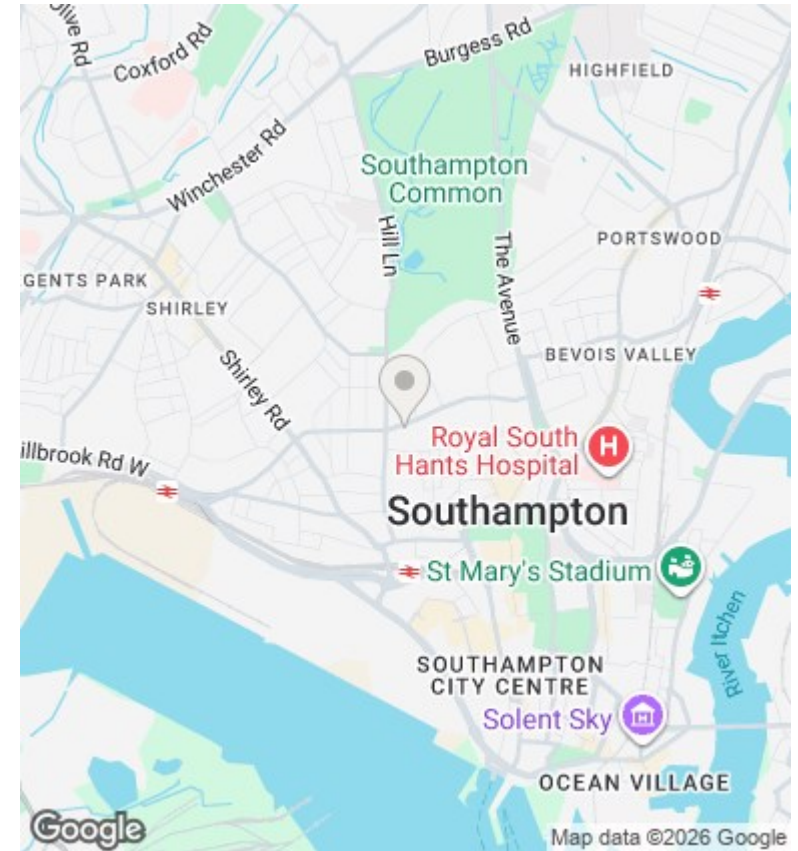

Directions

Viewings

Viewings by arrangement only. Call 02380 632632 to make an appointment.

Council Tax Band

C

EPC Rating:

C

Energy Efficiency Rating		Current	Potential
<i>Very energy efficient - lower running costs</i>			
(92 plus) A			
(81-91) B			
(69-80) C		80	80
(55-68) D			
(39-54) E			
(21-38) F			
(1-20) G			
<i>Not energy efficient - higher running costs</i>			
England & Wales		EU Directive 2002/91/EC	