

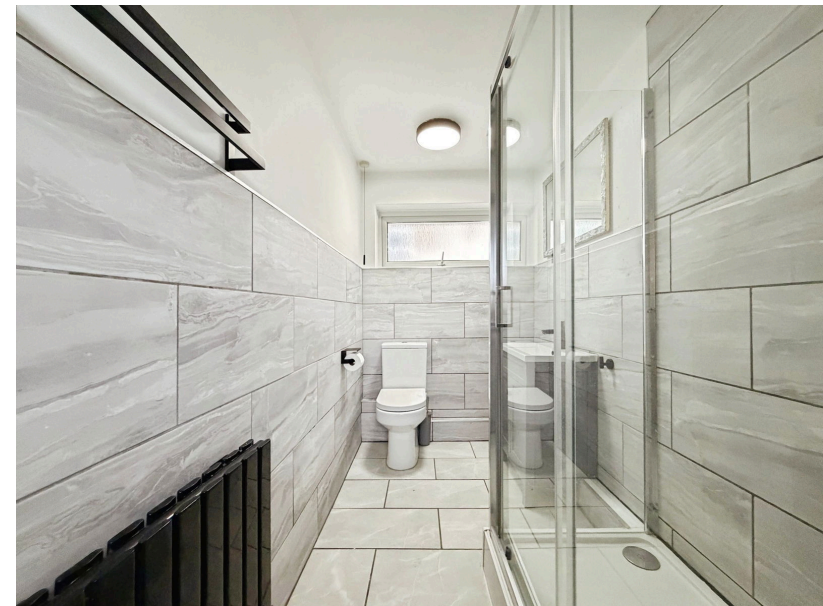

Crosswell Close, Sholing, SO19

Guide Price £180,000

🛏 1 🚿 1 🚿 1



- No Forward Chain
- First Floor Maisonette
- Driveway Parking
- Front And Rear Gardens
- Freehold Included
- Previously achieved £1000pcm
- Modern Shower Room
- Well Presented Throughout



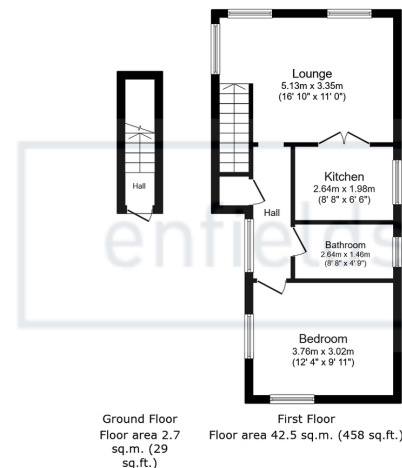

Total floor area: 45.3 sq.m. (487 sq.ft.)

This floor plan is for illustrative purposes only. It is not drawn to scale. Any measurements, floor areas (including any total floor area), openings and orientations are approximate. No details are guaranteed, they cannot be relied upon for any purpose and do not form any part of any agreement. No liability is taken for any error, omission or misstatement. A party must rely upon its own inspection(s). Powered by www.Propertybox.io

enfields

A first floor one double bedroom Maisonette with private front & rear garden, driveway and freehold included with no forward chain situated on the edge of a quiet cul-de-sac in Sholing. This location offers an array of local benefits and quick access routes to Southampton City and the M27 motorway. It's located close to local shops, a 24/7 access gym, and plenty of local walks.

This property is ideal for first time buyers and investors and is fantastically presented throughout. The accommodation comprises of spacious living/dining room, a modern and well equipped kitchen, stunning shower room and large double aspect bedroom. Externally, there driveway parking for one vehicle, an enclosed rear garden and a further garden to the front. Further benefits include the freehold, Double glazing and gas central heating. Also new Consumer Unit was installed in 2025 along side Gas and EIRC certificate.

www.enfields-southampton.co.uk

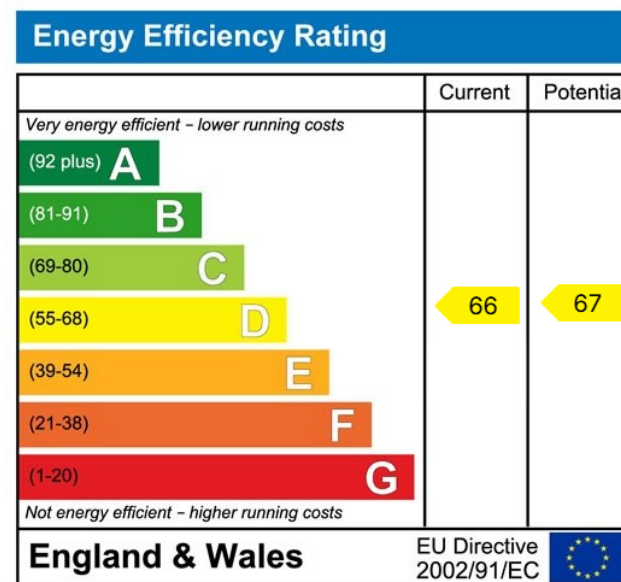

It is Enfields policy to respect any sole agency currently in force and we would not be able to commence marketing until this has expired or been terminated. If you fail to terminate any previous agreement you could be liable for two sets of fees. Enfields Hythe is a trading name of YTF LTD Registered office: 345 Shirley Road, Southampton, Hampshire, England, SO15 3JD. Company Registration No: 10459987. VAT Registration No: 281 2975 81.

Enfields Lettings - Embley Management LTD T/A Enfields. Registered Address: 345 Shirley Road, Southampton, Hampshire, England, SO15 3JD. Company Registration No: 14847604. VAT Registration No: 439 8546 45.