

While every attempt has been made to ensure the accuracy of the floorplan contained here, measurements of doors, windows, rooms and any other items are approximate and no responsibility is taken for any errors of detail, omissions or mis-statement. This plan is for illustrative purposes only and should be used as such. Any prospective purchaser, the services, options and appliances shown thereon have been issued and no guarantee as to their operability or efficiency can be given. Made with Metropix, 2020.

England & Wales	
EU Directive 2002/91/EC	
Very energy efficient - lower running costs	A (92 plus)
	B (81-91)
	C (69-80)
	D (55-68)
	E (39-54)
	F (21-38)
Not energy efficient - higher running costs	G (1-20)
Current	74
Potential	79

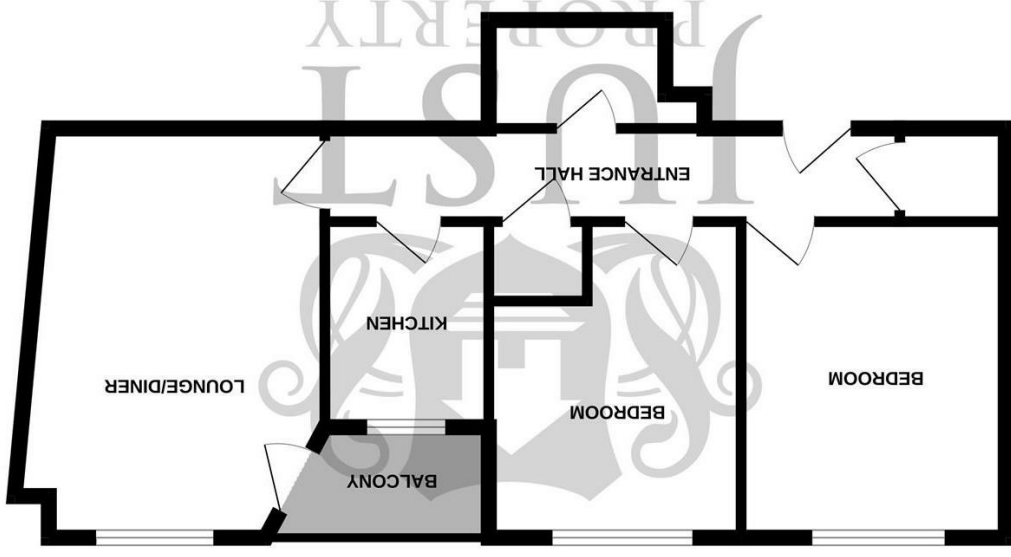

SECOND FLOOR



8 Sydenham Court Cantelupe Road, Bexhill-On-Sea, TN40 1JQ

FLOORPLANS

www.justproperty.net

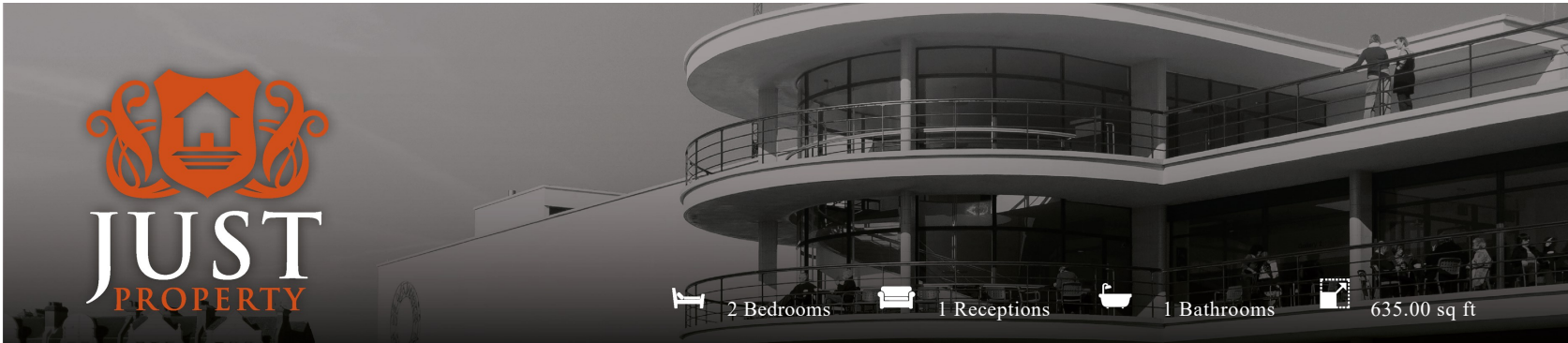

2 Bedrooms | 1 Receptions | 1 Bathrooms | 635.00 sq ft

Leasehold - Share of Freehold

£229,950

8 Sydenham Court Cantelupe Road, Bexhill-On-Sea, TN40 1JQ





PROPERTY DETAILS

CHAIN FREE

A beautifully presented two bedroom apartment with a private balcony, stunning sea views and allocated off road parking, enviably positioned within easy reach of the seafront, mainline railway station and the excellent range of shops and amenities at Ravenside Retail Park and Bexhill-on-Sea town centre. From independent eateries and cafés to the beach and promenade, everything you need for relaxed coastal living is close at hand, with direct rail links to London making it equally convenient for commuters.

Occupying the second floor of this well maintained purpose-built block, the apartment has been newly refurbished to create a stylish and inviting home ready to move straight into. The heart of the property is the bright and airy living room, where doors open onto a private balcony boasting far-reaching sea views — a wonderful setting for al fresco dining, morning coffee or unwinding at the end of the day.

The separate kitchen is thoughtfully fitted with contemporary units, integrated appliances and ample storage, combining practicality with a modern and contemporary finish. There are two generous double bedrooms, both enjoying a pleasant front aspect, complemented by a large shower room finished to a high standard.

Offered to the market with no onward chain and a share of the freehold, this impressive apartment would make a superb seaside home. A viewing is highly recommended to fully appreciate the lifestyle on offer.



ROOM DIMENSIONS

Communal Entrance

Residents Lift

Front Door

Hallway

Storage Cupboard x 2

Bedroom
11'8" x 9'8" (3.56 x 2.97)

Bedroom
11'8" x 9'3" (3.56 x 2.82)

Shower Room / WC

Fitted Kitchen
7'6" x 6'0" (2.31 x 1.83)

Lounge / Dining Room
15'5" x 11'8" (4.70 x 3.58)

Balcony - South Facing

FEATURES

- CHAIN FREE
- Share of Freehold - Balance of 999 Year Lease
- Totally Refurbished
- Purpose Built Apartment
- Two Double Bedrooms
- South Facing Balcony
- Secure Underground Parking
- Very Close To Town Centre & Station
- Sea views

