

ACACIA COURT, COLLAPIT CLOSE, HARROW



One Bedroom Top Floor Flat

Guide Price £225,000 to £250,000

Description

GUIDE PRICE £225,000 to £250,000.

Ideally situated in a quiet cul-de-sac location within a short walk to North Harrow station, this ONE DOUBLE bedroom second floor flat would benefit from updating and features generous sized rooms throughout. The flat consists of an Entrance Hall, large lounge/dining room, kitchen, master bedroom and a bathroom. BENEFITS include Double glazing, electric heating, Entryphone system, communal gardens and residents parking. No Upper Chain. Viewing advised.



Location:

Collapit Close is situated off Pinner Road





- **GUIDE PRICE**
£225,000 to £250,000.
One bedroom top (second) floor flat
- *Lease recently renewed*
- *Residents parking*
-
- *In need of updating*



Additional Information

TENURE. LEASEHOLD
LOCAL AUTHORITY. LONDON BOROUGH OF HARROW
ENERGY EFFICIENCY RATING.

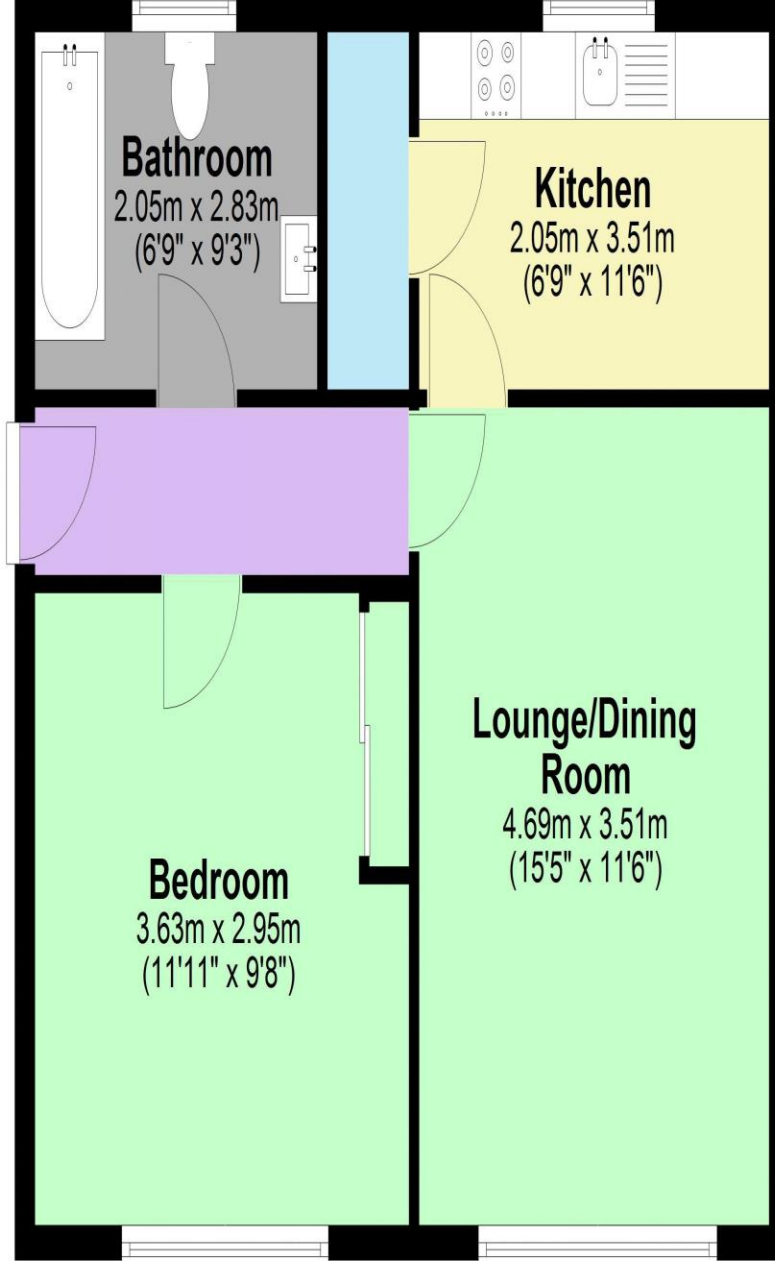

Second Floor

Approx. 50.4 sq. metres (542.1 sq. feet)

Total area: approx. 50.4 sq. metres (542.1 sq. feet)



We have not sought to verify the legal title of the property, the existence of planning permissions and/or building regulation approvals and have been unable to check the working condition of any services or appliances.

Property layouts are for general guidance and are not drawn exactly to scale. Measurements are taken at the widest points and bays, alcoves, wardrobes etc. may not be shown.