

Because life is

PettyTM
Real

30 Bispham Road
Nelson
BB9 0RX



For Sale

Price £95,000

- Mid-terrace property located on Bispham Road, Nelson
- Ideal opportunity for first-time buyers or investors
- Convenient location close to town centre, schools and transport links
- Garden frontage providing an attractive approach to the property
- Enclosed rear yard offering private, low-maintenance outdoor space
- Spacious lounge providing a comfortable main reception room

- Fitted kitchen with practical layout and good storage potential
- First floor bedroom accommodation accessed from central landing
- Family bathroom positioned on the first floor
- Offered for sale with no onward chain for a smooth purchase process



Situated on Bispham Road in Nelson, this mid-terrace property offers an excellent opportunity for a variety of buyers, including first-time purchasers and investors alike. The home is conveniently positioned close to local amenities, schools, transport links, and within easy reach of Nelson town centre, making it well placed for everyday living, offering excellent connectivity.

Externally, the property benefits from a garden frontage providing an appealing approach, and enjoys a pleasant frontage, while to the rear there is a private enclosed yard, offering a low-maintenance outdoor space ideal for seating or storage, ideal for first time buyers or investors.

The accommodation is arranged over two floors and provides well-proportioned living space throughout. On the ground floor there is a welcoming lounge and a fitted kitchen, creating a practical layout suited to modern lifestyles and ideal for both relaxation and dining.

To the first floor, the property continues with bedroom accommodation and a family bathroom, all accessed from a central landing. The layout offers comfortable and functional space, well suited to a small family or couple, with potential for personalisation.

Offered for sale with no onward chain, the property allows for a smooth and straightforward purchase process, subject to the usual conveyancing process. This is an ideal home for those looking to move quickly or add to a rental portfolio. rare opportunity

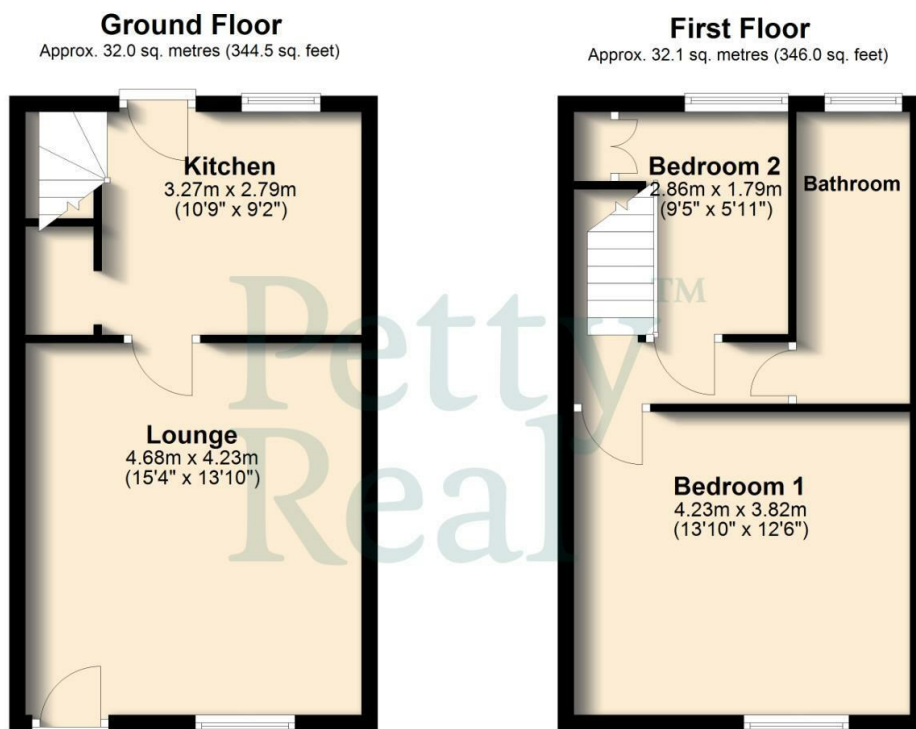

Total area: approx. 64.2 sq. metres (690.5 sq. feet)

All floorplans provided are for guidance only. Please check all dimensions before making any decisions reliant upon them.
Plan produced using PlanUp.



These particulars, whilst believed to be accurate are set out as a general outline only for guidance and do not constitute any part of an offer or contract. Intending purchasers should not rely on them as statements of representation of fact, but must satisfy themselves by inspection or otherwise as to their accuracy. No person in this firm's employment has the authority to make or give any representation or warranty in respect of the property.

11 Albert Road, Colne, Lancashire, BB8 0RY
T. 01282 868686
Colne.sales@pettyreal.co.uk

www.pettyreal.co.uk