



**Inglewood Grove, Sutton Coldfield - B74 3LN**  
**£850,000**





## Inglewood Grove

### Sutton Coldfield

Upon entering the home, one is greeted by an impressive hallway that sets the tone for what awaits within. The spacious living room features a charming log burner, offering a perfect retreat and ideal for cosy evenings with family. The solid roof conservatory beckons with French doors opening onto the inviting garden patio, flooding the space with natural light.

Prepare to be amazed by the heart of the home, a stunning extended open plan breakfast kitchen that embodies sophistication and functionality. Boasting high-end kitchen cabinets, quartz worktops, a large breakfast island and quality appliances along with roof windows and bi folding doors that lead out to the rear garden, this space is perfect for hosting gatherings or enjoying family meals. There is a utility room for added convenience.

A sitting room with a log burner is located directly off the kitchen and the family room perfect for comfortable gatherings is located at the front of the home. A stylish ground-floor bathroom completes the ground floor accommodation.







## Inglewood Grove

### Sutton Coldfield

Moving to the first floor, an impressive landing leads to the principal bedroom boasting a luxury en-suite, while three further double bedrooms, all equipped with 'Sharps' fitted wardrobes, share a luxurious family bathroom offering comfort and privacy for all. Outside, the resin bonded driveway ensures ample parking space for residents and guests alike, providing practicality within the luxurious surroundings.

The rear garden of this residence is a sanctuary of serenity and conviviality. The south-facing garden captivates with its immaculate upkeep, offering the perfect backdrop for relaxation or vibrant social gatherings. Unwind and rejuvenate in the high-quality gym/garden room, a space designed for wellness and recreation. Adjacent, the delightful bar area invites entertaining friends and family in a stylish ambience. Whether it's a morning yoga session or an evening cocktail party, the outdoor space of this property is versatile and inviting. Additionally, the garden is thoughtfully designed to cater to various activities, from al fresco dining under the sun to creating lasting memories with loved ones. Embrace the harmony of indoor-outdoor living in this meticulously curated setting, designed to elevate every moment and create lasting impressions.











#### FEATURES :

- Beautifully presented and extended family home
- Highly desirable location
- High spec finish throughout
- Stunning open plan breakfast kitchen with bi fold doors and utility room
- Spacious living room and sitting room with log burners
- Stylish bathrooms
- Immaculate south facing garden with high quality gym/garden room and bar
- Resin bonded driveway providing ample parking

INTERESTED?

0121 308 3355

[fouroaks@moorhouse-property.co.uk](mailto:fouroaks@moorhouse-property.co.uk)



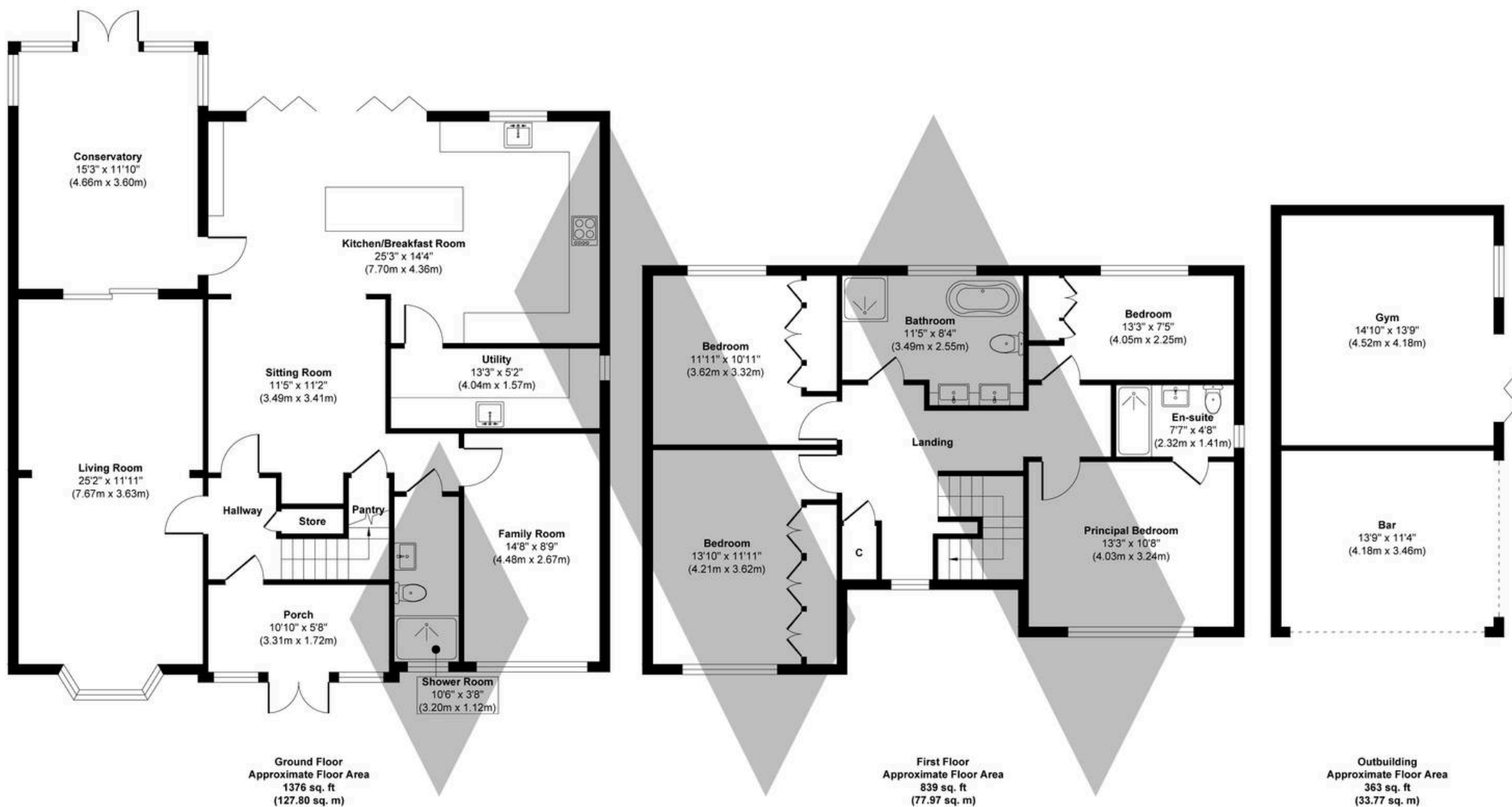

**Approx. Gross Internal Floor Area 2578 sq. ft / 239.54 sq. m (Including Outbuilding)**

Illustration for identification purposes only, measurements are approximate, not to scale.

Produced by Elements Property

# MOORHOUSE



You can include any text here. The text can be modified upon generating your brochure.